



RHINO-RACK

Isuzu MU-X LS-T / LS-U / LS-M Backbone - RIMB1

Fit Time: 1.5 Hours

Note: OEM roof rail removed.

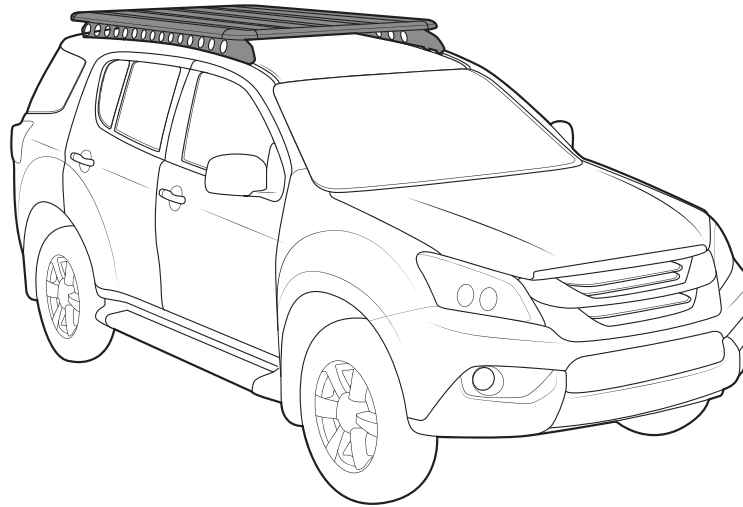

IMPORTANT INFORMATION

Maximum carrying capacity:

Suitable Pioneers	On Road Cargo Allowance	Off Road Cargo Allowance	Static Allowance	Roof Allowance	Rack Weight
42102B	85.5kg / 189lb	61.5kg/ 136lb	327kg / 721lb	120kg / 265lb	33kg / 73lb
45102B	83kg / 183lb	59kg/ 130lb	324.5kg / 715lb		35.5kg / 78lb
41102	80kg / 177lb	56kg/123lb	321.5kg / 709lb		38.5kg / 85lb
42107B	83kg / 183lb	59kg/130lb	324.5kg / 715lb		35.5kg / 78lb
45107B	80kg / 177lb	56kg/123lb	321.5kg / 709lb		38.5kg / 85lb
41107	77.5kg / 171lb	53.5kg/118lb	319kg / 703lb		41kg / 90lb

Roof Allowance: Total permissible weight attached to the roof of the car. This is inclusive of the weight of the roof rack system

Cargo Allowance: Total permissible weight allowed on top, and attached to roof racks whilst the vehicle is in motion

Static Allowance: Total permissible weight allowed on top, and attached to roof racks whilst the vehicle is stationary

Please refer to your vehicle manufacturers handbook for maximum carrying capacity. Always use the lower of the two figures. Load must be evenly distributed over the entire Pioneer. Weight of roof rack accessories is to be included in cargo allowance.

Warning:

- Check Part No. and/ or Kit is correct for use with your vehicle
- Do not attempt to fit the rack system to your vehicle unless you fully understand these fitting instructions. Please direct any questions regarding fitting to the dealer from where the roof racks were purchased.
- **Use only non-stretch fastening ropes or straps.**
- The handling characteristics of the vehicle changes when you transport a load on the roof. For safety reasons we recommend you exercise extreme care when transporting wind-resistant loads. Special consideration must be taken into account when cornering and braking.
- Although the system is tested and approved to AS1235-2000 / ISO 11154, off-road conditions can be much more rigorous. Extreme care must be taken in off road conditions

Recommendations:

It is essential that all bolt connections be checked after driving a short distance when you first install your roof racks. Bolt connections should be checked again at regular intervals (once a week is enough, depending on road conditions, usage, loads and distances travelled). You should also check the roof racks each time they are re-fitted. Always make sure to fasten your load securely. Please also ensure that all loads are evenly distributed and that the centre of gravity is kept as low as possible and must be entirely contained within the extents of the roof racks.

Note for Dealers and Fitters:

It is your responsibility to ensure these fitting instructions are given to the end user or client

Rhino-Rack, 3 Pike St, Rydalmere
NSW 2116, Australia
(02) 8846 1900
rhinorack.com.au

Document No: R1592
Prepared By: Kayle Everett
Authorised By: Chris Murty

Issue No: 02
Issue Date: 20/12/2017

These instructions remain the property of Rhino-Rack Australia Pty. Ltd. and may not be used or changed for any other purpose than intended.

Isuzu MU-X LS-T / LS-U / LS-M Backbone - RIMB1

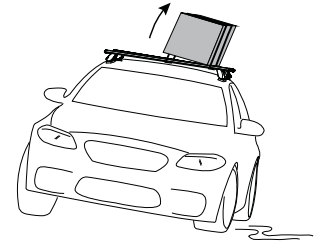
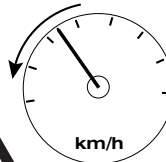
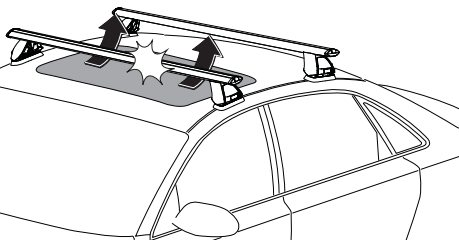
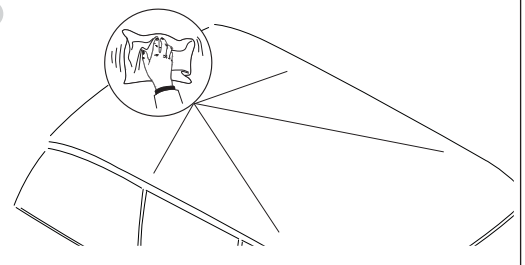
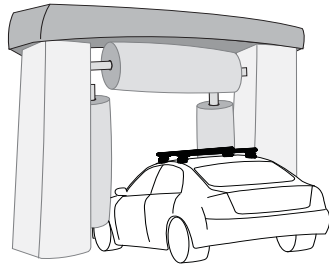
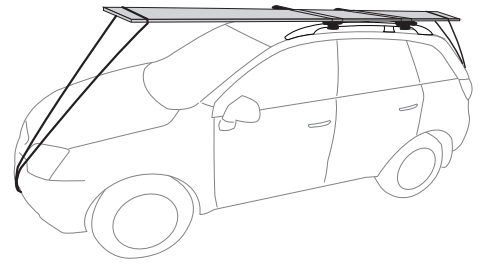
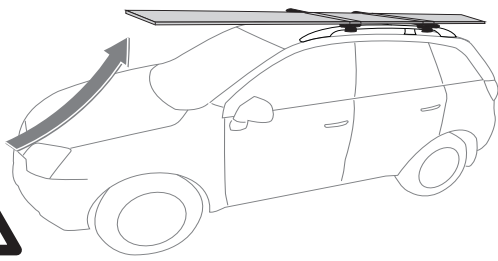

The handling characteristics of the vehicle changes when you transport a load on the roof. For safety reasons we recommend you exercise extreme care when transporting wind-resistant loads. Special consideration must be taken into account when cornering and braking.

Although the system is tested and approved to AS1235-2000 / ISO 11154, off-road conditions can be much more rigorous. Extreme care must be taken in off road conditions

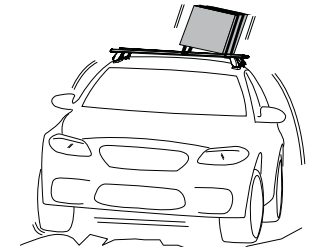
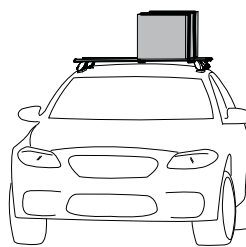

System Weight: 34.5 - 42kg

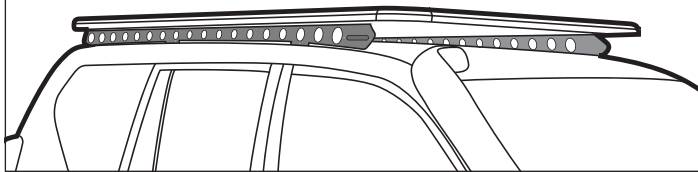

? kg

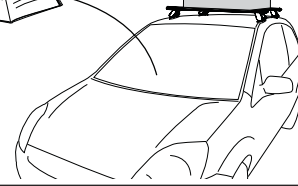

Static Load Rating: refer to front page



Ensure Ladder is well supported on the ground to help support tent. Take extreme caution when climbing heights above 1.2m/4ft.

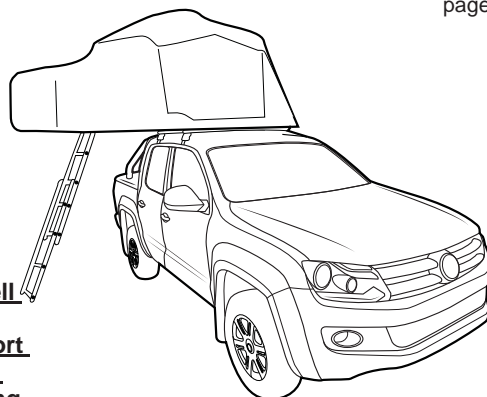

Paddle/ Surfboards should be fixed to the front of the vehicle.

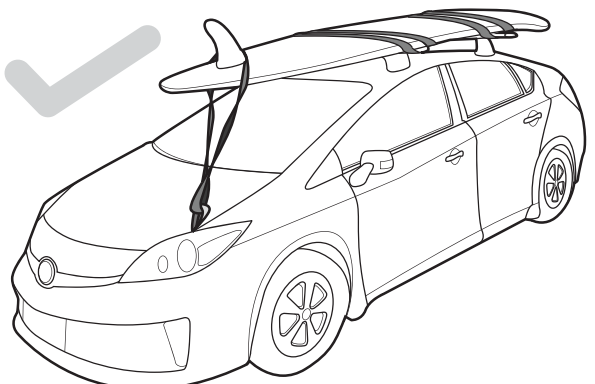

Isuzu MU-X LS-T / LS-U / LS-M Backbone - RIMB1

Parts List

Left Side Pictured

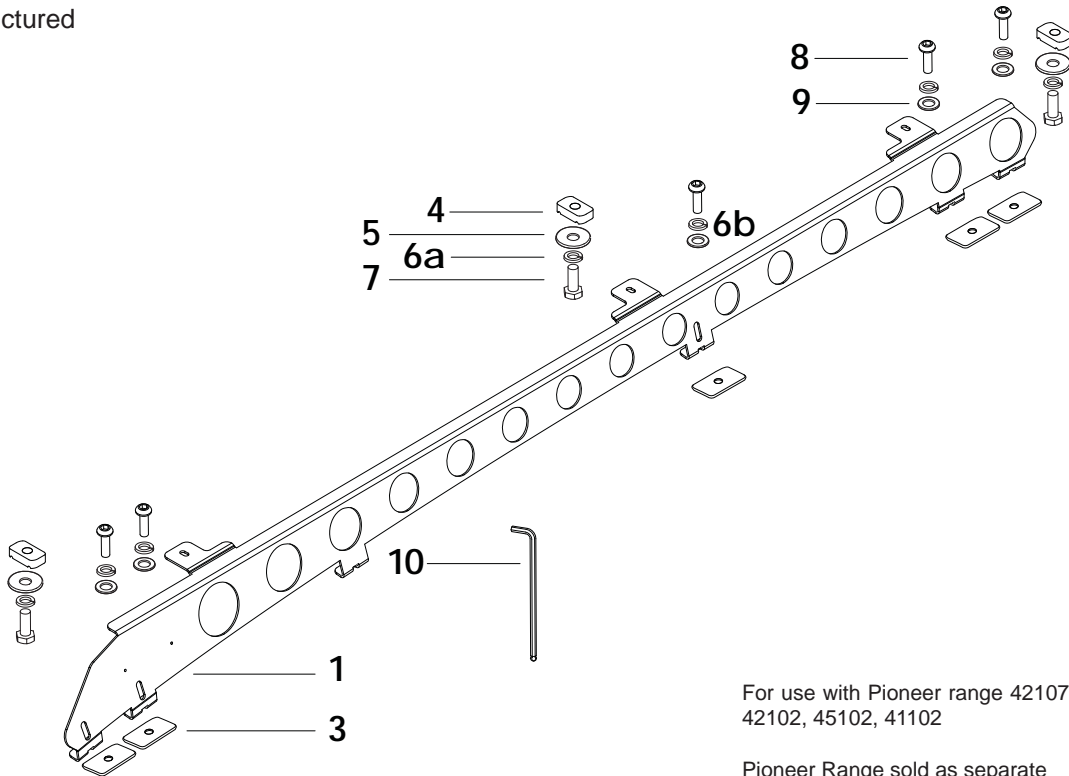

For use with Pioneer range 42107, 45107, 41107, 42102, 45102, 41102

Pioneer Range sold as separate

Item	RTPB1 Kit	Qty	Part No.
1	MU-X Left Hand Rail	1	CA1784
2	MU-X Right Hand Rail	1	CA1785
3	Butyl Patch 40x25 M8 Hole	12	CA1260
4	M8 Channel Nut	6	N003
5	M8x24x2mm Flat Washer	6	W043-BLK
6a	M8 Spring Washer black	6	W019-BLK
6b	M8 Spring Washer silver	12	W019
7	M8x25 Hex Setscrew	6	B169
8	M8x25 Button Head Screw	12	B140
9	M8x19mm Flat Washer	12	W043
10	Short 5mm Ball End Key	1	-
11	Instructions	1	R1451

Tools Required:

- Torx Key 25
- 12mm Socket Wrench
- Tape Measure
- Cleaning rags/ products, vacuum
- Socket wrench
- 13mm Ring Spanner (LS-U/LS-M)
- Nylon Scrape
- Wax and Grease Remover
- Marker
- Stock and Die
- Chisel
- Drill, 3mm drill bit and 9.5mm drill bit
- Die grinder
- Wax and grease remover

LS-U / LS-M Preparation (For LS-T go to page 5)

- 1** A) Measure back 205mm from the tool mark at the front of the ditch. Create a reference with a marker. B) Use a chisel and strike the ditch mould at this point. C) Lift the ditch mould out from the rear to this point.

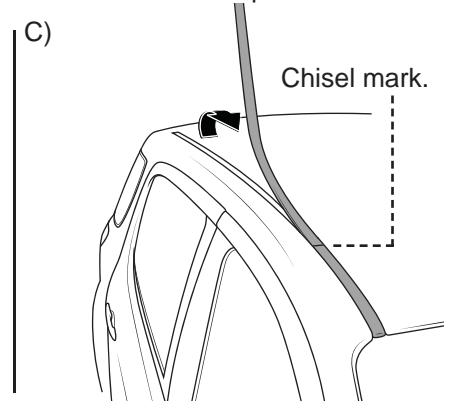
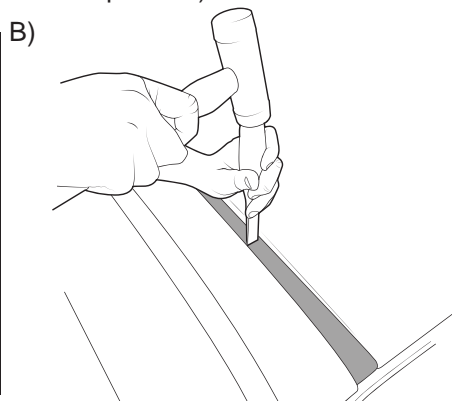
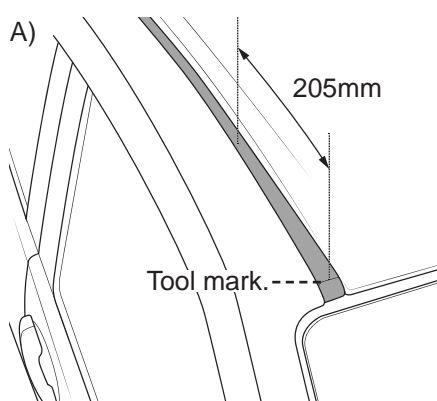

Isuzu MU-X LS-T / LS-U / LS-M Backbone - RIMB1

2 Move the mould back and forth at the chisel strike. The mould should break off. Finish off with cutters if required.

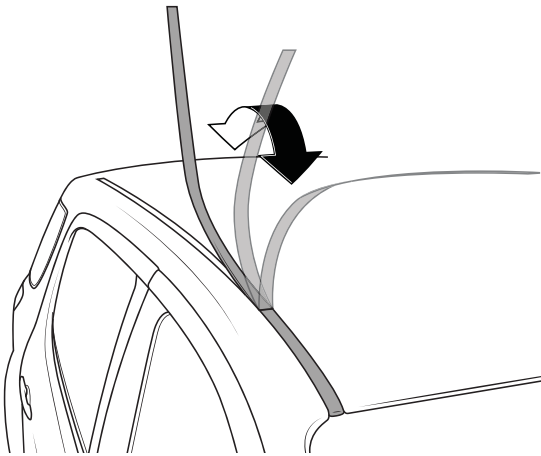

3 Using a nylon scrape, remove any material from inside the ditch. Note: Wax and grease remover will loosen the adhesive.

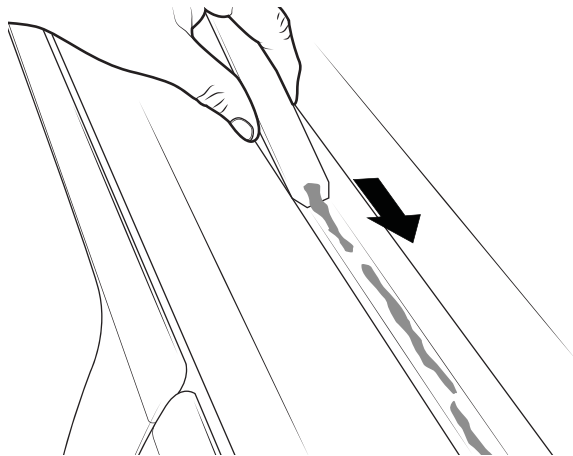

4 Measure 220mm back towards the front of the ditch. Create a reference in the centre of the ditch.

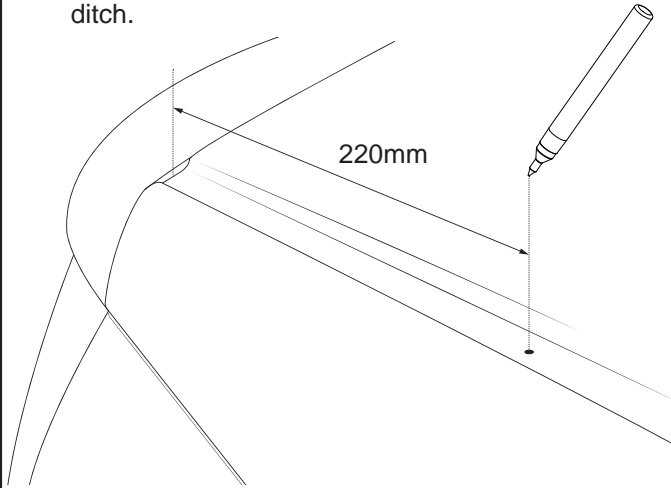

5 Use a 3mm drill bit and drill through the ditch at this reference. You should drop through into a threaded cavity, use caution and drill slowly.

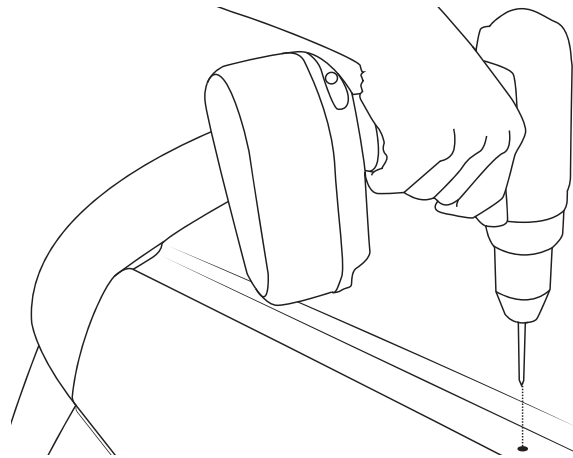

6 Drill through the surface with a 9.5mm drill bit. Inspect the hole drilled previous first, as you may have to adjust for centre.

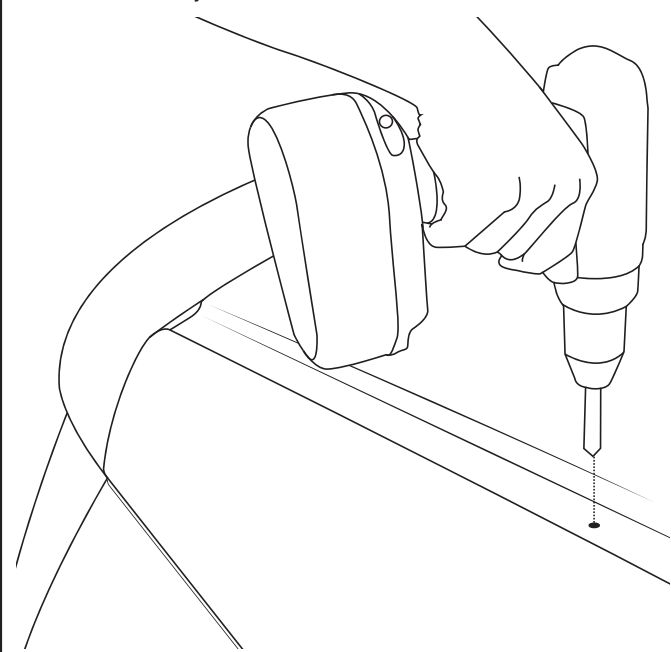

7 **Optional Step:** A) Carefully die grind the hole to clear of burrs. B) Clean and re-tap threads as required. Vacuum any swarf from the roof.

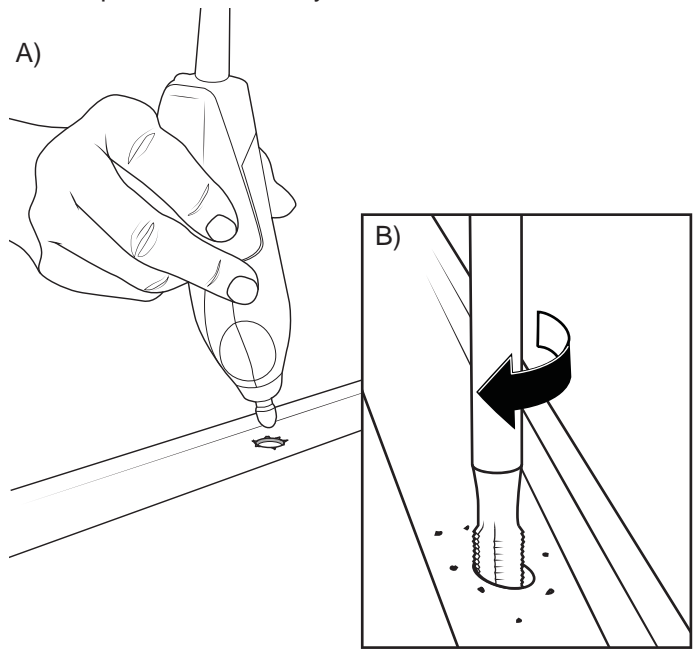

Isuzu MU-X LS-T / LS-U / LS-M Backbone - RIMB1

- 8** A) Place one side of the Backbone onto the roof of the vehicle. Screw the rear mounting point in place using the newly exposed thread. B) Mark the mounting points onto the track using the backbone as a reference.

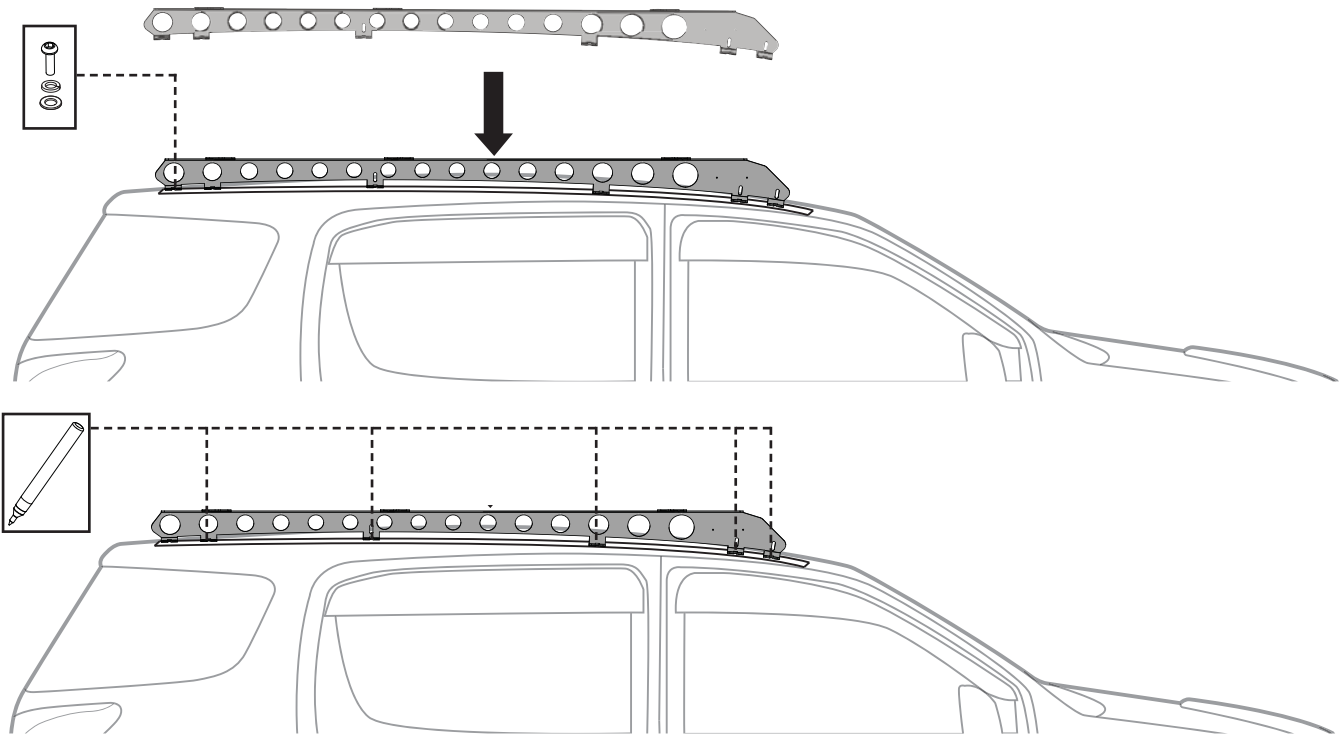

- 9** Remove the backbone and repeat the techniques used in steps 5, 6 and 7 for all the references made in the ditch. Vacuum any swarf.

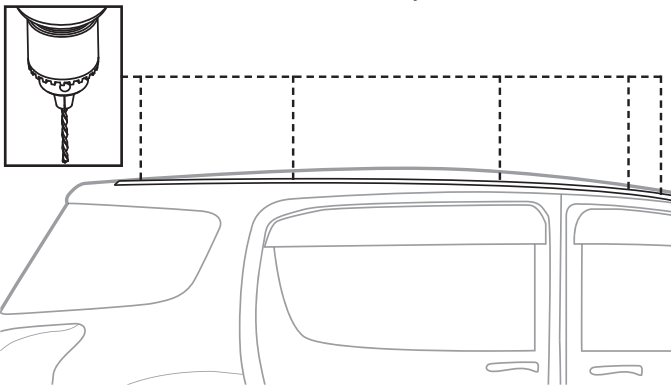

- 10** Using cold galvanising paint, cover all holes and exposed body work.

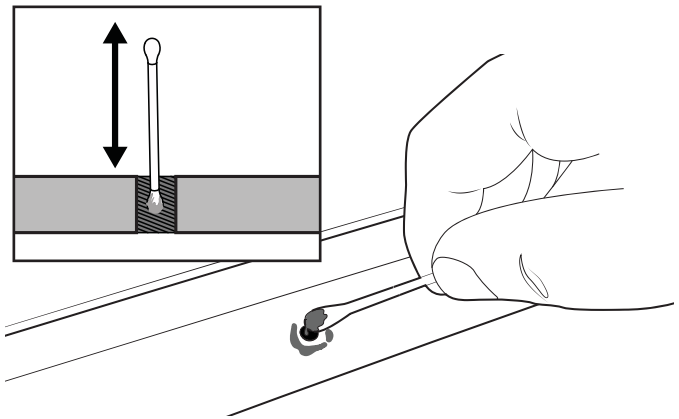

LS-T Preparation

- 1** Move to the end caps of the factory rails. 1: Hook a hand over to the inside of the end cap, pull towards the outside of the vehicle. 2: Carefully lift and twist upward, pull forward to remove.

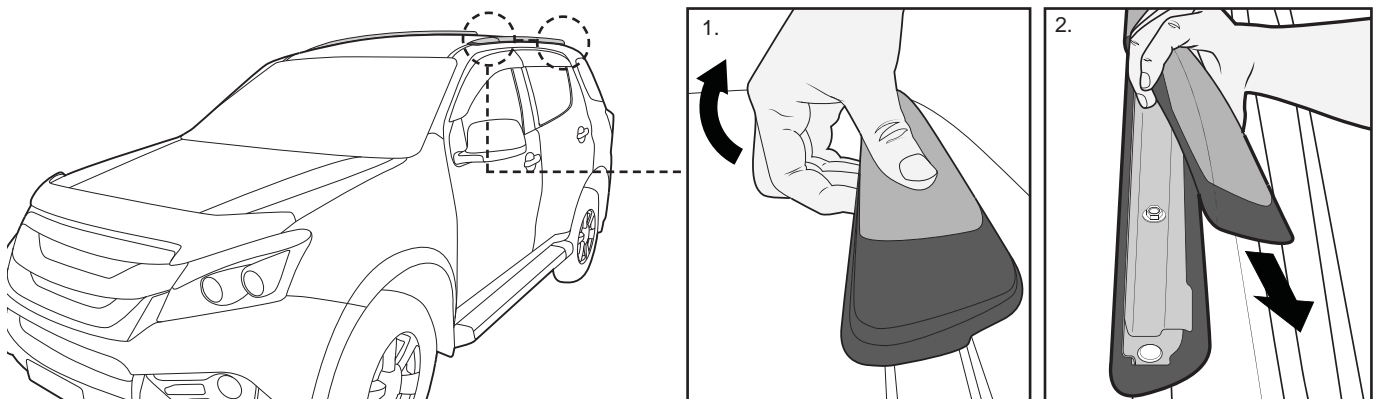

Isuzu MU-X LS-T / LS-U / LS-M Backbone - RIMB1

2 Use a Torx 25 Screw Driver to remove the screws in the newly opened cavities.

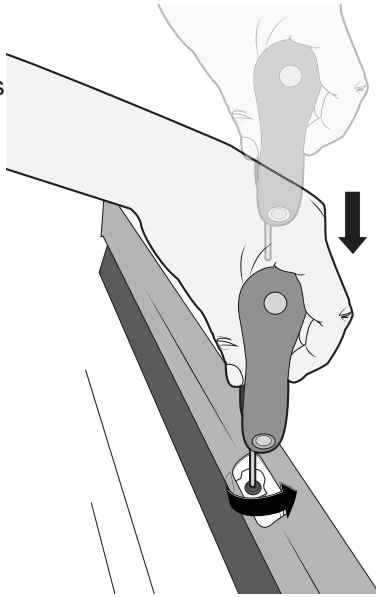

3 Pull the rails off by hooking hands under the inside edge of the rail and pulling towards the outside of the car.

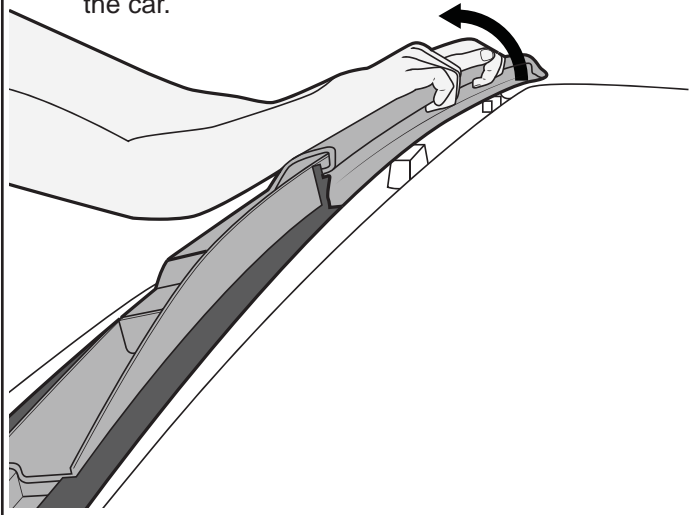

4 Using a 12mm socket wrench, remove the two blocks within the exposed roof ditch. Repeat for each side of the vehicle.

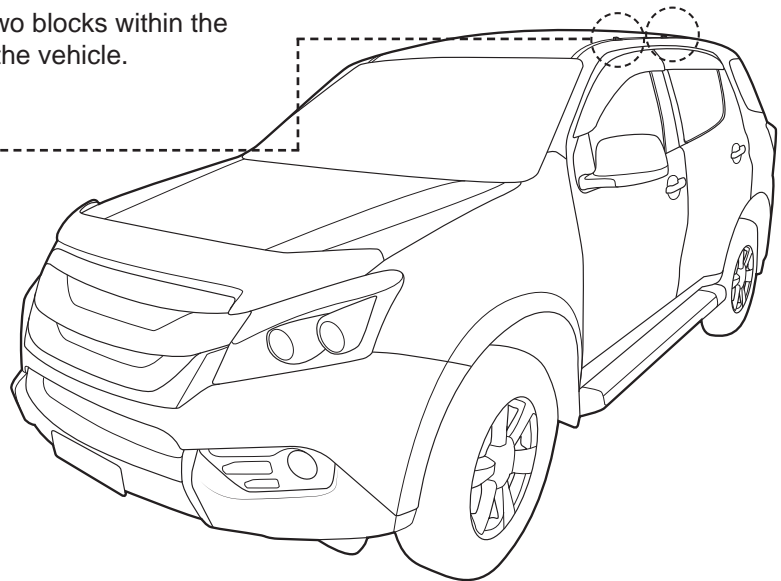
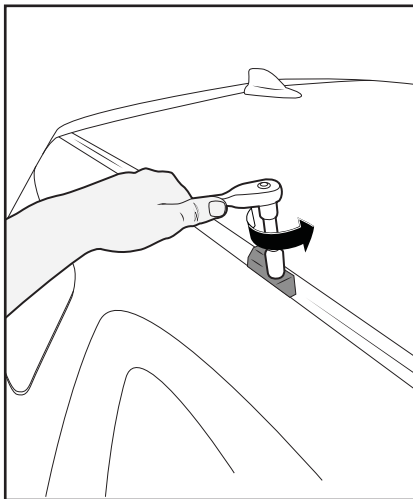

Backbone Installation

1 Remove backing tape of the butyl patch and position over the top of mounting holes. Ensure patch has adhered to channel surface securely. Repeat this step for all mounting points.

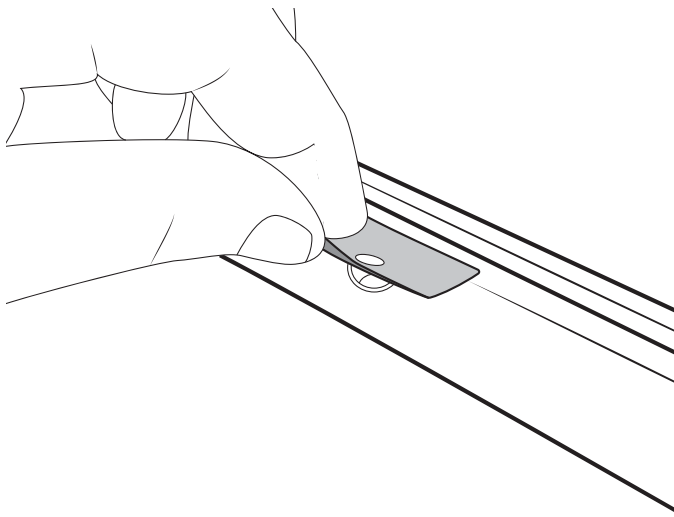

2 Once all butyl patches are placed, remove top cover tape, revealing just the Butyl. This will create a watertight seal and protect the paint from metal contact.

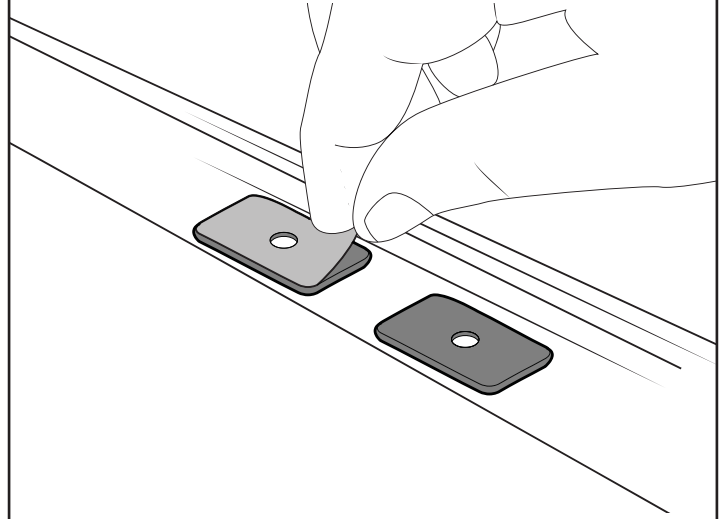

Isuzu MU-X LS-T / LS-U / LS-M Backbone - RIMB1

- 3** Place one side of the Backbone onto the roof of the vehicle. Line up the mounting points of the bracket to the those exposed on the roof in the previous steps.

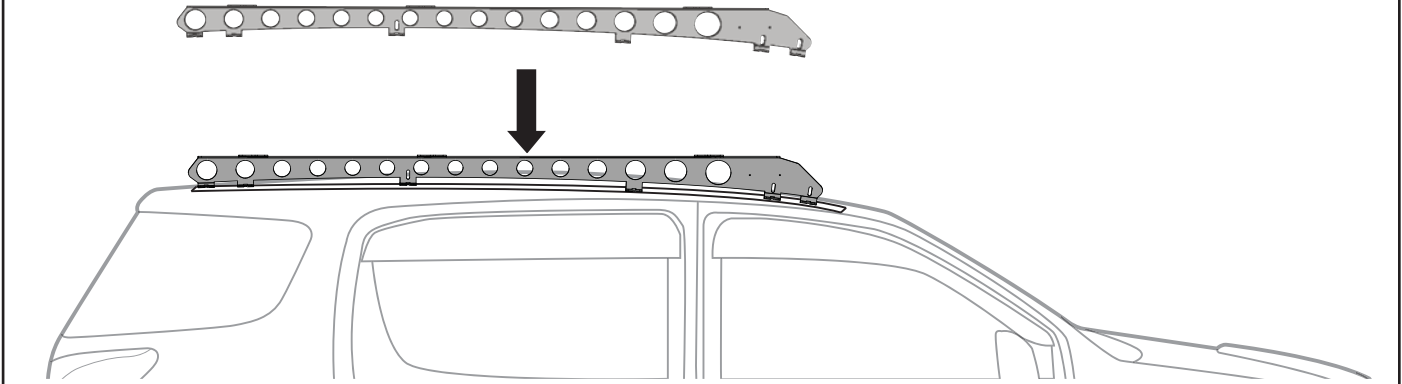

- 4** Using the M8 button screw, M8 spring and flat washer, place hardware into mounting holes of rails. Make sure hardware and holes align with fixed roof mounts before proceeding.

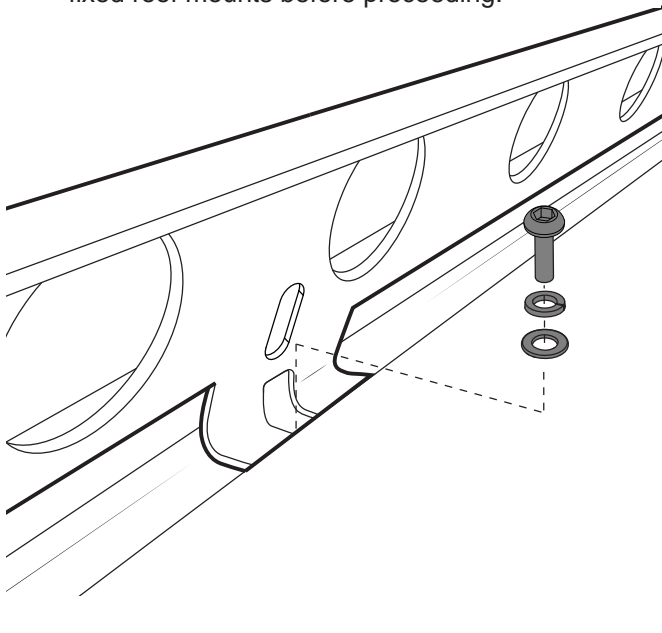

- 5** Start securing backbone by tightening M8 socket hardware into the roof fixed mount points. Improve speed of installation by tightening as much as possible using 6mm ball end allen key.

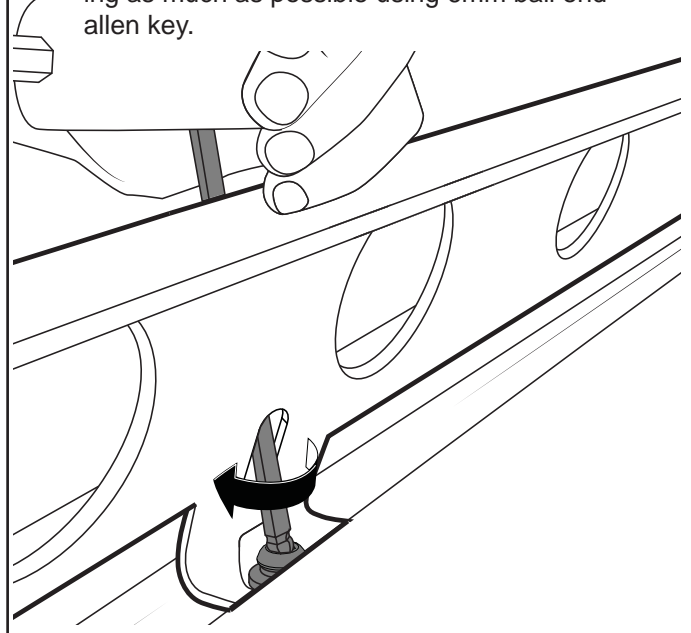

- 6** After all bolts have been tightened as much as possible with the ball end allen key - tighten completely using the opposite end of the allen key.

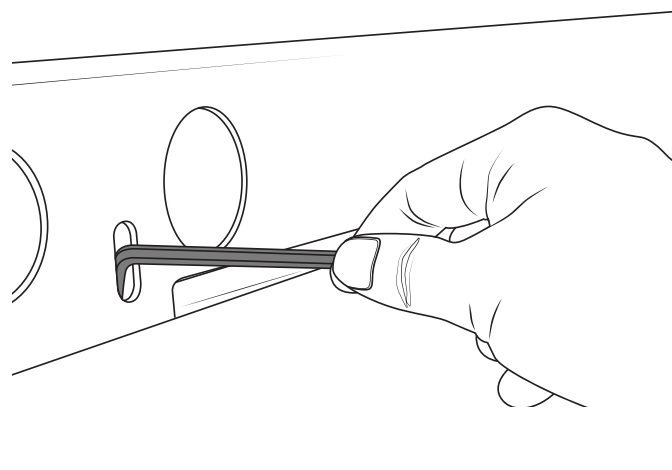

- 7** Repeat steps 3-6 for securing opposite side Backbone rail. Ensure both plates are securely positioned on the car. Check each bolt before proceeding to attaching the Pioneer tray to the backbone rails.

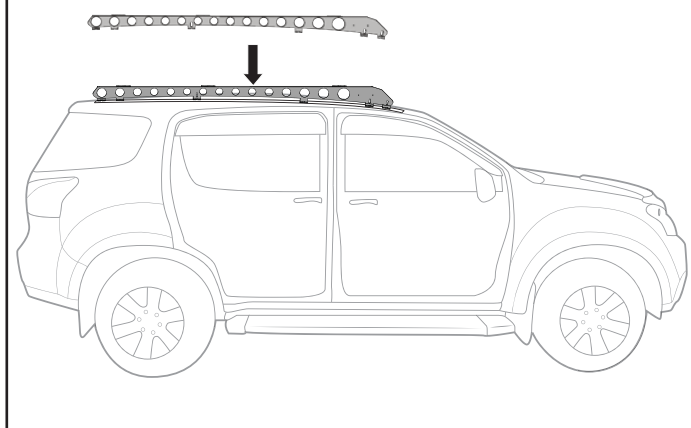

Isuzu MU-X LS-T / LS-U / LS-M Backbone - RIMB1

8 Assemble M8 hardware as pictured below. Complete this for the six tabs on top of the backbone rails (3 each rail).

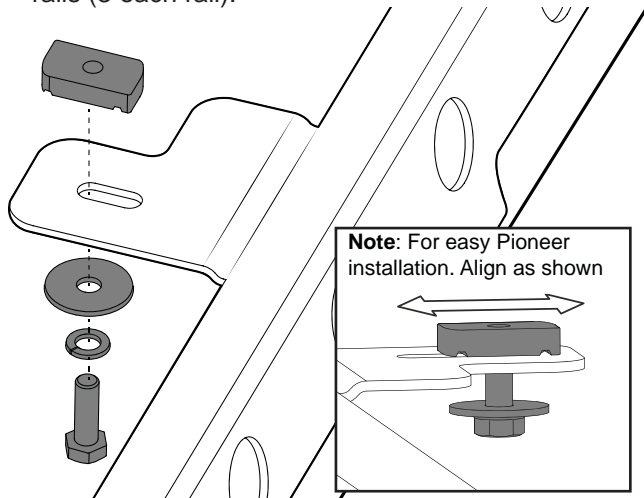

9 Install Pioneer underbars into positions indicated. For detailed instruction - refer to pioneer fitting sheets 2128mm long trays (42107, 45107, 41107)

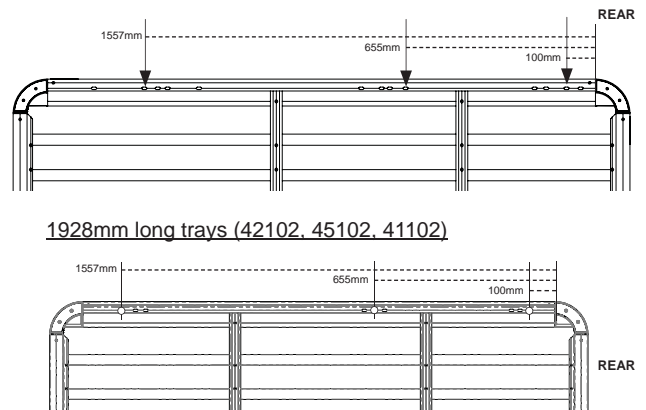

10 After underbars have been correctly fitted, place the Pioneer tray on top of the Backbone rails. Align the underbars with the top tabs and ensure the M8 hardware fits into underbar channel.

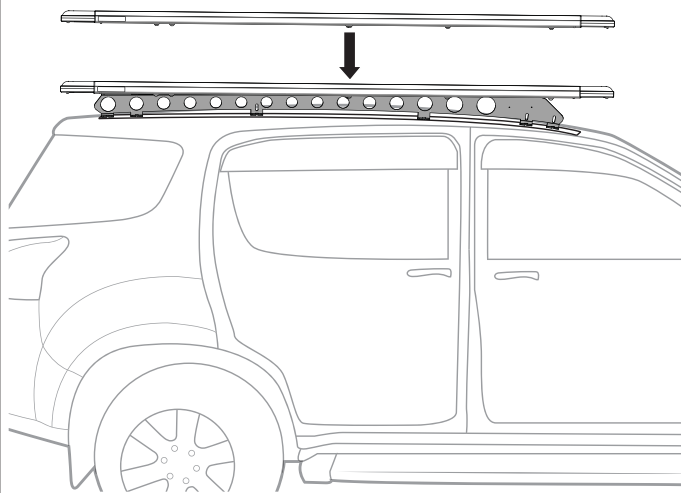

11 Once Pioneer underbars have been aligned properly, tighten all M8 hardware using 13mm socket wrench or 13mm spanner. Ensure channel nut has rotated within Pioneer underbar and is fixing Pioneer securely.

