

HOLDEN RA RODEO, ISUZU, GREAT WALL 2003 –07/12

PART NO: RCRO03

*Failure to connect coloured wiring correctly and tape up all connections as described in following instructions will result in an electrical short and void console warranty.*

For this installation you will need a **hand held** Phillips screwdriver, 3.5mm 'stubby' drill bit, small electric drill, electrical insulation tape and 'Loc-Tite'.

**Vehicle preparation:** Switch interior light to off position, unscrew and remove interior light, disconnect wiring and put away for refit at a later date. Remove map lights/sunglasses holder if installed in vehicle; to do this grip with fingers and pull out of clips holding it to roof, unplug wires and put away with interior light.

**Rear Fixing Plate installation:** Fit small piece of rubber edging supplied over metal edge of interior light hole.



Using a **hand held** Phillips screwdriver fasten Rear Fixing Plate to the two vacant interior light screw holes. Fasten plate through **marked holes** using original interior light screws ensuring that captive nuts are to **front** of vehicle and interior light wiring/plug protrudes out side of plate where rubber edging is installed. Fasten yellow earth wire to one of these screws.

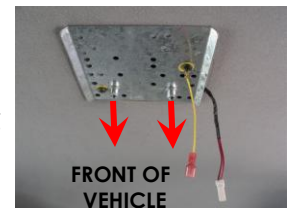

**Installation preparation:** Connect wiring adaptor supplied to console wiring loom; connect **red** to **red**, **white** to **white**. Tape up connections.



Fasten Front Mounting Bracket on **inside** of Roof Console using two (2) 6mm x 16mm **black** round head bolts supplied.



**Comfortable work position:** Slide seats all way back, if right handed, sit in passenger seat; if left handed sit in driver seat.

Stand console upright on front seat and plug console wiring adaptor into interior light wiring of vehicle; connect **white** pin on wiring adaptor into **red/grey** wire of interior light plug, connect **red** pin into **red/white** wire and **yellow** into **yellow** earth wire fastened to Rear Fixing Plate. Close doors and check that console lights work independently once timer switches off then tape up to ensure wires do not become disconnected.

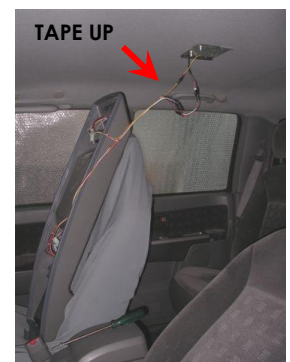

There is an on/off switch located behind front lights, when 'off' it acts as a kill switch; no lights will work. When 'on' lights will work independently as map/interior lights when doors are shut and timer switches off. When doors are opened lights will work as door/interior lights.

Use 'Blu-Tack' in fit kit to adhere one of the 6mm x 25mm round head bolts to **hand held** Phillips screwdriver, put a small amount of 'Loc-Tite' on thread and store in convenient location, eg: on seat of vehicle or in/on centre console.

### ***Console installation:***

Hold console up in position in centre of vehicle then look under and up into rear mounting hole; line up captive nuts in Rear Fixing Plate with slotted fastening holes. Using the 6mm x 25mm round Phillips head bolt 'Blu-Tacked' to your **hand held** Phillips screwdriver **loosely** fasten rear of console up to one of captive nuts in Rear Fixing Plate.

'Blu-Tack' other 6mm x 25mm round head bolt to screwdriver, apply 'Loc-Tite' and **loosely** fasten into Rear Fixing Plate.

Insert 'stubby' 3.5mm drill bit into electric drill **ensuring only 25mm of drill bit is protruding out of chuck.** Slide Console forward as far as it will go. Hold Front Mounting Bracket hard up under hood lining and drill up through left hand hole in Front Mounting Bracket into inner skin of vehicle. **Note:** You are only drilling into the inner skin not the roof itself. Fasten bracket using one of the 10# x 25mm countersunk Phillips screws with plastic snap cap washer under head (do up firm but do not over tighten screw so as to deform snap cap washer). Drill up through right hand hole in Front Mounting Bracket in same manner and fasten using other 10# x 25mm countersunk screw with snap cap washer under head. 'Snap' on the two **grey** coloured snap caps over screw heads.

Now tighten rear bolts. **NOTE:** *Only tighten rear bolts up firm so console is held to roof. **DO NOT** keep tightening so as to bend rear mounting plate downwards. Do rear bolts up with equal tension.*

Open Locker Box and remove Microphone Cable Holder and Rear Mounting Hole Cover from inside; fasten Hole Cover in place using screws supplied. Fasten Microphone Cable Holder in place as per radio installation instructions.

### **Fit Kit: RCRO03**

- One (1) Front Mounting Bracket
- One (1) Rear Fixing Plate
- One (1) Yellow earth wire
- One (1) Wiring adaptor
- One (1) 30mm piece of rubber edging
- Two (2) 6mm x 16mm **black** round head Phillips bolts
- Two (2) 6mm x 25mm round head Phillips bolts
- Two (2) 10# x 25mm countersunk Phillips self tapping screws
- Two (2) Plastic snap cap washers
- Two (2) **Grey** snap caps
- One (1) Small piece of 'Blu-Tack'
- Three (3) 100mm pieces of sticky back foam

# RADIO INSTALLATION

## Radio Insert Installation: for smaller size radios

**PLEASE NOTE: Radio Inserts NOT INCLUDED.**

Decorative side of insert faces outwards and snaps out over bottom of tray surround.

To install insert, squeeze top and bottom together; push/bend sides and squeeze into tray surround from inside to outside until bottom lip on decorative side of insert snaps/pops out over bottom of tray surround, prize with fingers to ensure bottom lip of insert is in place over tray surround as described. **Do not** scratch or mark insert or surround by prising/levering with tools; use hands/fingers only.



### Radio Installation:

Place protective cover on work bench to avoid scratching console. Place console on protective cover and using a sharp knife cut a 30mm x 100mm section out of storage tray 25mm in from where rear of radio will be when installed. Use a small amount of methylated spirits on a clean cloth to clean exposed part of console and bottom rear of radio.

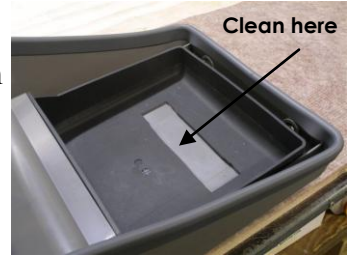

Peel one side of protective backing from foam strip supplied; apply pressure with palm of hand to adhere foam to exposed part of console. Peel backing off other side of foam strip and add one or more strips of foam to suit different size radios (see chart below). This will keep radio level with bottom of surround.



Insert radio on an angle until radio protrudes 15mm out over bottom of tray surround or insert and straighten; lay flat onto sticky back foam and apply firm pressure to top of radio with palm of hand for 30 seconds to ensure good adhesion.



### Sticky back foam chart:

- One (1) strip- standard size radios
- Two (2) strips- Icom and Uniden
- Three (3) strips- GME Electrophone

### Microphone and Microphone Cable Holder installation:

Install in a position that suits best, depending on vehicle and Radio model. Ensure microphone or microphone cable and holder does not foul on sun visor when pulled down.



Microphone clip on slight angle



Left hand cable outlet radios



Microphone clip on acute angle