

INSTALLATION OF 'OUTBACK' ROOF CONSOLE

Nissan Navara D22 Dual Cab - 1997 to 03/15

Part No. RCNAV97

Failure to connect coloured wiring correctly and tape up all connections as described in following instructions will result in an electrical short and void console warranty.

For this installation you will need a **hand held** Phillips screwdriver, very small screwdriver (hole locator), electrical insulation tape and 'Loc-Tite'.

VEHICLE PREPARATION:

Swing Sun Visors around to side and lay flat to roof for ease of installation. Switch interior light to off position, remove interior light, disconnect wiring and put aside for refit at a later date, retain screws.

Standard models: Remove rear view mirror.

Models with factory map lights: Remove map lights first then rear view mirror. To remove lights; pull down from front of light housing and unclip from roof, disconnect wiring, wrap insulation tape around plug and tuck out of way in roof void.

Rear Fixing Plate installation: Using a **hand held** Phillips screwdriver fasten Rear Fixing Plate to two vacant interior light screw holes. Use original interior light screws and fasten plate through **marked** holes ensuring captive nuts are to **front** of vehicle and interior light wires protrude out front of plate. Fasten yellow earth wire supplied to one of these screws.

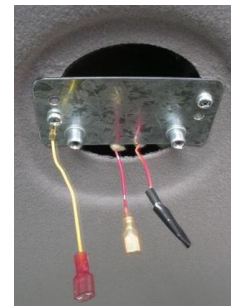

INSTALLATION PREPARATION:

Connect wiring extension supplied to console wiring loom; connect **red to red, white to white and yellow to yellow**. Tape up connections.

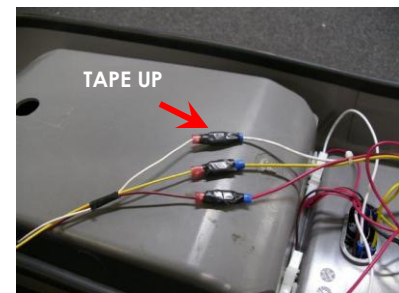

Front Mounting Bracket: Fasten Front Mounting Bracket supplied to **inside** front of Console using two (2) 6mm x 16mm **black** round head Phillips bolts supplied.



Comfortable work position: Slide seats all way back, if right handed, sit in passenger seat; if left handed, sit in driver seat.

CONSOLE INSTALLATION:

Stand console upright on front seat and plug console wiring into interior light wiring of vehicle. Connect **male** to **female**, **female** to **male** and **yellow** to **yellow** earth wire fastened to Rear Fixing Plate. Check that console lights work independently once doors are shut and timer switches off then tape up to ensure wires do not become disconnected.



There is an on/off switch located in behind of front lights, when off it acts as a kill switch and no lights will work; when on lights work independently as map/interior lights when doors are shut and timer switches off; when doors are opened lights will work as door/interior lights.

Use 'Blu-Tack' in fit kit to adhere one of the 6mm x 30mm round head bolts to **hand held** Phillips head screw driver, put a small amount of 'Loc-Tite' on thread and store in convenient location, eg: on seat of vehicle or in/on centre console.

Position Console in centre of vehicle then look up under and into rear mounting hole; line up captive nuts in Rear Fixing Plate with slotted fastening holes, tuck wiring loom out of way so as not jam between console body and fixing plate. Use the 6mm x 30mm round head Phillips bolt 'Blu-Tacked' to your Phillips screw driver and **loosely** fasten rear of console up to one of captive nuts in Rear Fixing Plate.

Slide console back or forth, locate original mirror screw holes using a very small screwdriver (locating tool) through the three rear holes in Front Mounting Bracket, fasten using three 10# x 25mm countersunk screws with clear snap cap washers under screw heads. Tighten firm; but do not over tighten screws so as to deform snap cap washers; then snap on **grey** snap caps.

Fasten rear view mirror into remaining holes in Front Mounting Bracket using three 10# x 12mm **black** self tapping screws (this moves mirror forward and down to ensure clear vision). Place anti vibration rubber supplied between nipple on mirror stem and windscreen. Replace mirror cover (Standard models only).

Blu-Tack other 6mm x 30mm round head bolt to screw driver, apply 'Loc-Tite', fasten into Rear Fixing Plate and tighten. Now tighten other rear bolt. **Note:** *Only tighten rear bolts up firm so as console is held to roof, **do not** keep on tightening so as to bend rear mounting plate downward; do rear bolts up with equal tension.*

Open Locker Box and remove Microphone Cable Holder and Rear Mounting Hole Cover from inside; fasten Hole Cover in place using screws supplied. Fasten Microphone Cable Holder in place as per radio installation instructions.

Fit plastic mirror base cover supplied over base of rear view mirror.

Fit Kit: RCNAV97

- 1 x Front Mounting Bracket
- 1 x Rear Fixing Plate (colour marked)
- 1 x Wiring extension
- 1 x Yellow earth wire
- 2 x 6mm x 16mm **black** Phillips round head bolts
- 2 x 6mm x 30mm Phillips round head bolts
- 1 x Plastic mirror base cover
- 3 x 10# x 25mm countersunk Phillips screws
- 3 x Plastic snap cap washers
- 3 x **Grey** snap caps
- 3 x 10# x 12mm **black** Phillips self tapping screws
- 1 x Rubber tube (for rear view mirror)

- 1 x Small piece of 'Blu-Tack'
- 3 x 100mm sticky back foam piece

RADIO INSTALLATION

Radio Insert Installation: for smaller size radios

PLEASE NOTE: Radio Inserts NOT INCLUDED.

Decorative side of insert faces outwards and snaps out over bottom of tray surround.

To install insert, squeeze top and bottom together; push/bend sides and squeeze into tray surround from inside to outside until bottom lip on decorative side of insert snaps/pops out over bottom of tray surround, prize with fingers to ensure bottom lip of insert is in place over tray surround as described. **Do not** scratch or mark insert or surround by prising/levering with tools; use hands/fingers only.



Radio Installation:

Place protective cover on work bench to avoid scratching console. Place console on protective cover and using a sharp knife cut a 30mm x 100mm section out of storage tray 25mm in from where rear of radio will be when installed. Use a small amount of methylated spirits on a clean cloth to clean exposed part of console and bottom rear of radio.



Peel one side of protective backing from foam strip supplied; apply pressure with palm of hand to adhere foam to exposed part of console. Peel backing off other side of foam strip and add one or more strips of foam to suit different size radios (see chart below). This will keep radio level with bottom of surround.



Insert radio on an angle until radio protrudes 15mm out over bottom of tray surround or insert and straighten; lay flat onto sticky back foam and apply firm pressure to top of radio with palm of hand for 30 seconds to ensure good adhesion.



Sticky back foam chart:

- One (1) strip- standard size radios
- Two (2) strips- Icom and Uniden
- Three (3) strips- GME Electrophone

Microphone and Microphone Cable Holder installation:

Install in a position that suits best, depending on vehicle and Radio model. Ensure microphone or microphone cable and holder does not foul on sun visor when pulled down.



Microphone clip on slight angle



Left hand cable outlet radios



Microphone clip on acute angle