



OUTBACK ROOF CONSOLE



INSTALLATION OF 'OUTBACK' ROOF CONSOLE

Nissan GQ 1988-1997

PART NO. RCGQ

Failure to connect coloured wiring correctly and failure to tape up all connections as described in following instructions will result in an electrical short and void console warranty.

For this installation you will need a long Phillips screwdriver, a stumpy Phillips screwdriver, 10mm ring spanner, wire crimping pliers or similar, wire cutters and insulation tape.

VEHICLE PREPARATION:

Swing Sun Visors around to side and lay flat to roof for ease of installation.

Remove rear view mirror, Light pod if fitted and retain screws.

Switch interior light to off position, remove from roof and cut off original plug. To do this, simply cut one wire at a time. Cut red wire, strip end and crimp on female terminal. Repeat procedure for black/pink wire. Cut black wire and tape up as not required. *Female terminals supplied will clip into your interior light upon replacement. Put light and screws in a safe place for refit upon resale of vehicle.

Rear Fixing Plate installation: Using a hand held Phillips screw driver fasten Rear Fixing Plate to two interior light screw holes. Use two 10# x 12mm Phillips self tapping screws provided and fasten plate through marked holes ensuring captive nuts point down and face rear of vehicle and interior light plug protrudes out R/H side of plate. Fasten yellow earth wire supplied to one of these screws.

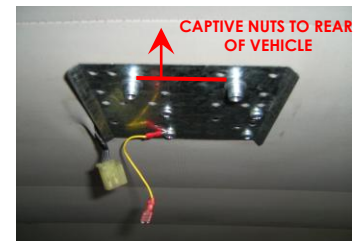

INSTALLATION PREPARATION:

Connect wiring extension supplied to console wiring loom; connect red to red, white to white and yellow to yellow. Tape up connections.

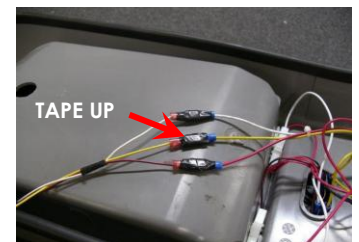

Fasten Front Mounting Bracket supplied to inside front of Roof Console using two (2) 6mm x 16mm black Phillips round head bolts supplied.



Use 'Blu Tack' provided to adhere one of 6mm x 25mm round head Phillips bolts supplied to Phillips screw driver and store in a convenient location, e.g: on seat of vehicle or in/on centre console.

Comfortable work position: Slide seats all way back, if right handed, sit in passenger seat; if left handed, sit in driver seat.

CONSOLE INSTALLATION:

Stand console upright on front seat and plug console wiring into interior light plug of vehicle. Plug **white** wire on console into **black/pink wire** of interior light plug, **red** into **red** wire and **yellow** into **yellow** earth wire fastened to Rear Fixing Plate. Check that console lights work independently once doors are shut and timer switches off then tape up to ensure wires do not become disconnected.



Position console in centre of vehicle then look up under and into rear mounting hole; line up captive nuts in Rear Fixing Plate with slotted fastening holes, tuck wiring loom out of way so as not jam between console body and rear mounting plate. Use the 6mm x 25mm round head Phillips bolt 'Blu Tacked' to your Phillips screw driver and **loosely** fasten rear of console up to one of captive nuts in Rear Fixing Plate.

Line Front Mounting Bracket holes up with rear view mirror screw holes and push front of console **firmly** up against roof. Screw rear view mirror back into place through Front Mounting Bracket using original screws and replace plastic cover.

- **VEHICLES WITH MAP LIGHTS FITTED:** **LOOSELY** fasten the two (2) 6mm x 16mm countersunk bolts with clear plastic snap cap washers into the two outside holes in the front mounting plate. These fasten into the two original map light bolt holes. Now tighten all fittings including the one in the locker box and replace your rear view mirror. Snap decorative snap caps onto the 6mm x 16mm countersunk bolts.
- **VEHICLES WITHOUT MAP LIGHTS FITTED:** Two original map light bolt holes are under the hood lining, simply poke Phillips head screwdriver up through the two outside holes in the front mounting plate to pierce hood lining. Then follow the above instructions for vehicles with map lights fitted.

'Blu Tack' other 6mm x 25mm round head Phillips bolt to screwdriver and fasten into remaining captive nut in Rear Fixing Plate. Tighten both rear bolts. **Note:** *Only tighten bolts up firm so as console is held to roof, **do not** keep on tightening so as to bend rear mounting plate downward; do rear bolts up with equal tension.*

Open Locker Box and remove Microphone Cable Holder and Rear Mounting Hole Cover from inside; fasten Hole Cover in place using screws supplied. Fasten Microphone Cable Holder in place as per radio installation instructions.

There is an on/off switch located in front of front lights, when off it acts as a kill switch and no lights will work; when on lights work independently as map/interior lights when doors are shut and timer switches off; when doors are opened lights will work as door/interior lights.

Fit Kit: RCGQ

- One (1) Front Mounting Bracket
- One (1) Rear Fixing Plate (colour marked)
- One (1) Wiring extension
- One (1) Yellow earth wire
- Two (2) Female terminals
- Two (2) 10# x 12mm Phillips self tappers
- Two (2) 6mm x 16mm countersunk Phillips bolts
- Two (2) 6mm x 16mm **black** Phillips round head bolts
- Two (2) 6mm x 25mm Phillips round head bolts
- Two (2) Decorative snap caps with washers
- One (1) Small piece of 'Blu Tack'
- Three (3) x 100mm Sticky back foam pieces

RADIO INSTALLATION

Radio Insert Installation: for smaller size radios

PLEASE NOTE: Radio Inserts NOT INCLUDED

Decorative side of insert faces outside and snaps out over bottom of tray surround.

To install insert, squeeze top and bottom together; push/bend sides and squeeze into tray surround from inside to outside until bottom lip on decorative side of insert snaps/pops out over bottom of tray surround, prize with fingers to ensure bottom lip of insert is in place over tray surround as described.

Do not scratch or mark insert or surround by prizing/levering with tools; use hands/fingers only.



Radio Installation:

Place protective cover on work bench to avoid scratching console.

Place console on protective cover and using a sharp knife cut a 30mm x 100mm section out of storage tray 25mm in from where rear of radio will be when installed. Use a small amount of methylated spirits to a clean cloth to clean exposed part of console and bottom rear of radio.



Peel one side of protective backing from strip of foam supplied; apply pressure with palm of hand to adhere foam to exposed part of console. Peel other side of backing off one or more strips of foam and apply to first for different size radios (see chart below) this will keep radio level with bottom of surround.



Insert radio on an angle until radio protrudes 15mm out over bottom of tray surround or insert and straighten; lay flat onto sticky back foam and apply firm pressure to top of radio with palm of hand for 30 seconds to ensure good adhesion.



Sticky back foam chart:

One (1) strip- standard size radios

Two (2) strips- Icom and Uniden

Three (3) strips- GME Electrophone

Microphone and Microphone Cable Holder installation:

Install in a position that suits best, depending on vehicle. Ensure microphone or microphone cable holder does not foul on sun visor when pulled down.



Install microphone clip on slight angle
(same as console)



Install microphone clip on acute angle