

INSTALLATION OF 'OUTBACK' ROOF CONSOLE

79 SERIES LANDCRUISER CAB CHASSIS 08/99 – CURRENT

PART NO. RC79CC

Failure to connect coloured wiring correctly and to tape up all connections as described in following instructions will result in an electrical short and void console warranty.

For this installation you will need a **hand held** Phillips head screwdriver a short 3.5mm 'stubby' drill bit, small electric or battery drill, 4.5mm & 3mm Allen keys and electrical insulation tape. All mounting plates, brackets and hardware supplied in fit kit.

VEHICLE PREPARATION:

Swing sun visors around to side and lay flat to roof for ease of installation.

Remove rear view mirror and anti vibration rubber; put aside with console for installation.

Switch your interior light to off position; remove light; retain screws. Insert a 3.5mm drill bit into drill ensuring only **20mm** of drill bit protrudes out of drill chuck; carefully drill into top edge of interior light hole, fasten yellow earth wire to this hole using the 10# x 12mm self tapping screw.



Rear Mounting Bracket Installation: Using a 3mm Allen key **loosely** fasten Rear Mounting Bracket to interior light screw holes using the two 4mm x 20mm **black** socket head screws; ensure captive nuts are facing **upwards**; allow all wiring to hang out top of bracket.



Using a Phillips screwdriver fasten Front Mounting Bracket to **inside** front of console using the two 6mm x 16mm **black** round head bolts.



Connect wiring extension supplied in fit kit to console wiring loom; **red to red, white to white and yellow to yellow. Tape up all connections.**

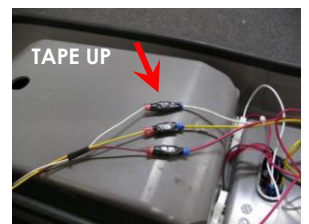

CONSOLE INSTALLATION:

Stand console upright on seat and connect console wiring into interior light wiring of vehicle; connect **red to red, white to black** (or **pink** – V8 models) and **yellow to yellow** earth wire. Check that console lights work independently once doors are shut and timer switches off, then tape up connections to ensure wires do not become disconnected.

There is an on/off switch located in front of front lights, when off it acts as a kill switch and no lights will work; when on lights work independently as map/interior lights when doors are shut and timer switches off; when doors are opened lights will work as door/interior lights.

Hold console up in position, line holes in front mounting bracket up with rear view mirror fixing holes, **loosely** fasten into place using **one** of the original mirror fastening screws.

Look up from underneath and **loosely** fasten rear of console into captive nuts in Rear Mounting Bracket using two 6mm x 20mm **black** socket head bolts and 6mm black plastic washers

Remove original screw from Front Mounting Bracket and fasten rear view mirror back in place.

Put anti vibration rubber back in place between mirror and windscreen.

Tighten rear bolts. **NOTE:** *Only tighten rear bolts up firm so console is held to bracket. **DO NOT** tighten so as to deform console. Do rear bolts up with equal tension.*

Open Locker Box and remove Microphone Cable Holder and Rear Mounting Hole Cover from inside; fasten Hole Cover in place using screws supplied. Fasten Microphone Cable Holder in place as per radio installation instructions.

Fit Kit: RC79CC

- 1 Front Mounting Bracket
- 1 Rear Mounting Bracket
- 1 Yellow Earth wire
- 1 Wiring extension
- 1 10# x 12mm Phillips head self tapping screw
- 2 4mm x 20mm **black** socket head set screw
- 2 6mm x 16mm **black** round head Phillips bolt
- 2 6mm x 20mm **black** socket head set screw
- 2 6mm plastic washers
- 3 100mm Sticky back foam

RADIO INSTALLATION

Radio Insert Installation: for smaller size radios

PLEASE NOTE: Radio Inserts NOT INCLUDED.

Decorative side of insert faces outwards and snaps out over bottom of tray surround.

To install insert, squeeze top and bottom together; push/bend sides and squeeze into tray surround from inside to outside until bottom lip on decorative side of insert snaps/pops out over bottom of tray surround, prize with fingers to ensure bottom lip of insert is in place over tray surround as described. **Do not** scratch or mark insert or surround by prising/levering with tools; use hands/fingers only.



Radio Installation:

Place protective cover on work bench to avoid scratching console. Place console on protective cover and using a sharp knife cut a 30mm x 100mm section out of storage tray 25mm in from where rear of radio will be when installed. Use a small amount of methylated spirits on a clean cloth to clean exposed part of console and bottom rear of radio.

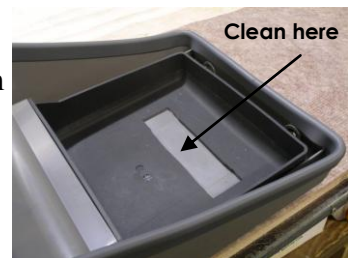

Peel one side of protective backing from foam strip supplied; apply pressure with palm of hand to adhere foam to exposed part of console. Peel backing off other side of foam strip and add one or more strips of foam to suit different size radios (see chart below). This will keep radio level with bottom of surround.



Insert radio on an angle until radio protrudes 15mm out over bottom of tray surround or insert and straighten; lay flat onto sticky back foam and apply firm pressure to top of radio with palm of hand for 30 seconds to ensure good adhesion.



Sticky back foam chart:

- One (1) strip- standard size radios
- Two (2) strips- Icom and Uniden
- Three (3) strips- GME Electrophone

Microphone and Microphone Cable Holder installation:

Install in a position that suits best, depending on vehicle and Radio model. Ensure microphone or microphone cable and holder does not foul on sun visor when pulled down.



Microphone clip on slight angle



Left hand cable outlet radios



Microphone clip on acute angle