

INSTALLATION OF 'OUTBACK' ROOF CONSOLE

100 SERIES LANDCRUISER GXL 08/02 – 2007 (with FACTORY FITTED CONSOLE)

PART NO. RC10003GXL

Failure to connect coloured wiring correctly and tape up all connections as described in following instructions will result in an electrical short and void console warranty.

For this installation you will need a short 'stubby' 3.5mm drill bit, electric drill, insulation tape, **long** Phillips screwdriver, **short** Phillips screw driver, small flat blade screwdriver and 4mm Allen key.

VEHICLE PREPARATION:

Swing Sun Visors around to side and lay flat to roof for ease of installation.

Removal of Original Console: Switch your interior light to 'off' position and remove console from roof; to do this remove two outside rear light lenses using a small flat bladed screwdriver as a lever (lever from front of light lenses) then open glasses compartments; front and third from front, this exposes five Phillips head set screws. Undo and remove the five set screws. Using hands only pull console down from the front so as to unclip console from framework in roof. Unplug both sets of wires.

Removal of Framework from under Roof Lining: Undo the six 6mm hex head bolts holding frame work to roof. Slide frame back past first void in roof lining and then out forward on an angle. Clip console and frame back together and wrap in packaging along with original set screws and hex head bolts for resale of vehicle if needed.

Rear Fixing Plate installation: Using a **hand held** Phillips screw driver fasten Rear Fixing Plate to four screw holes in the rear roof rib using four (4) 12# x 12mm Phillips self tapping screws provided. Fasten plate through **marked holes** ensuring captive nuts point down and face **front** of vehicle.



INSTALLATION PREPARATION:

Connect console wiring extension supplied to console wiring loom; connect **red** to **red**, **white** to **white** and **yellow** to **yellow**.

Tape up all connections.

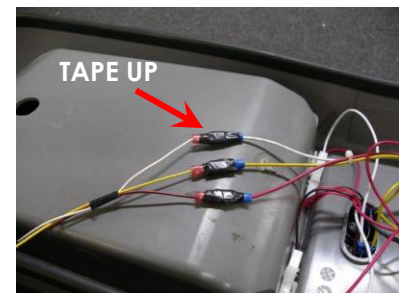

Fasten Front Mounting Bracket supplied to **inside** front of Roof Console using two (2) 6mm x 16mm **black** Phillips round head bolts supplied.



Use 'Blu Tack' provided to adhere one of the 6mm x 25mm round head Phillips bolts supplied to Phillips screw driver and store in a convenient location, eg: on seat of vehicle or in centre console. Stand console upright on front seat and plug console wiring into **three pin** interior light socket in vehicle; plug **red** into **red** wire of interior light socket, **white** into **green/white** and **yellow** into **white/grey**. Check that console lights work independently once doors are shut and timer switches off then tape up to ensure wires do not become disconnected.



Comfortable work position: Slide seats all way back; if right handed, sit in passenger seat; if left handed, sit in driver seat.

CONSOLE INSTALLATION:

Hold console up to roof in centre of vehicle then look up under and into rear mounting hole; line up captive nuts in Rear Fixing Plate with slotted fastening holes, tuck wiring loom out of way so as not jam between console body and rear mounting plate. Use the 6mm x 25mm round head Phillips bolt 'Blu Tacked' to your Phillips screw driver and **loosely** fasten rear of console up to one of captive nuts in Rear Fixing Plate.

There are two 5mm bolt holes set 15mm apart located above the rear view mirror. Hold console up in **exact** centre of roof and **loosely** fasten up through slotted hole in front mounting plate into corresponding 5mm bolt hole using 5mm x 20mm **black** socket head set screw and 6mm plastic washer supplied. Pull console rearwards so Front Mounting Bracket fits snug into contour of roof lining then **fasten** 5mm x 20mm set screw.

Insert short 'stubby' 3.5mm drill bit into electric drill ensuring only **20mm** of drill bit is protruding out of drill chuck. Drill up through two outside holes in Front Mounting Bracket and fasten using two (2) 12# x 20mm **black** Phillips self tapping screws supplied.

'Blu Tack' other 6mm x 25mm round head Phillips bolt to screwdriver and fasten into remaining captive nut in Rear Fixing Plate. Tighten both rear bolts. **Note:** Only tighten bolts up firm so as console is held to roof, **do not** keep on tightening so as to bend rear mounting plate downward; do rear bolts up with equal tension.

Open Locker Box and remove Microphone Cable Holder and Rear Mounting Hole Cover from inside; fasten Hole Cover in place using screws supplied. Fasten Microphone Cable Holder in place as per radio installation instructions.

There is an on/off switch located in front of front lights, when off it acts as a kill switch and no lights will work; when on lights work independently as map/interior lights when doors are shut and timer switches off; when doors are opened lights will work as door/interior lights.

Fit Kit: RC10003GXL

- One (1) Front Mounting Bracket
- One (1) Rear Fixing Plate (colour marked)
- One (1) Console wiring extension
- Four (4) 12# x 12mm Phillips self tapping screws
- Two (2) 12# x 20mm **black** Phillips self tapping screws
- Two (2) 6mm x 16mm **black** Phillips round head bolts
- Two (2) 6mm x 25 mm Phillips round head bolts
- One (1) 5mm x 20mm **black** socket head set screw
- One (1) 6mm plastic washer
- One (1) Small piece of 'Blu Tack'
- Three (3) x 100mm Sticky back foam pieces

RADIO INSTALLATION

Radio Insert Installation: for smaller size radios

PLEASE NOTE: Radio Inserts NOT INCLUDED.

Decorative side of insert faces outwards and snaps out over bottom of tray surround.

To install insert, squeeze top and bottom together; push/bend sides and squeeze into tray surround from inside to outside until bottom lip on decorative side of insert snaps/pops out over bottom of tray surround, prize with fingers to ensure bottom lip of insert is in place over tray surround as described. **Do not** scratch or mark insert or surround by prising/levering with tools; use hands/fingers only.



Radio Installation:

Place protective cover on work bench to avoid scratching console. Place console on protective cover and using a sharp knife cut a 30mm x 100mm section out of storage tray 25mm in from where rear of radio will be when installed. Use a small amount of methylated spirits on a clean cloth to clean exposed part of console and bottom rear of radio.

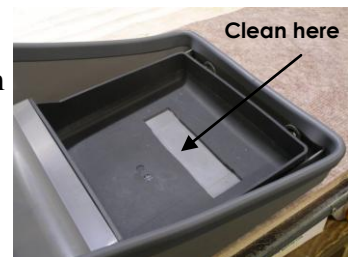

Peel one side of protective backing from foam strip supplied; apply pressure with palm of hand to adhere foam to exposed part of console. Peel backing off other side of foam strip and add one or more strips of foam to suit different size radios (see chart below). This will keep radio level with bottom of surround.



Insert radio on an angle until radio protrudes 15mm out over bottom of tray surround or insert and straighten; lay flat onto sticky back foam and apply firm pressure to top of radio with palm of hand for 30 seconds to ensure good adhesion.



Sticky back foam chart:

One (1) strip- standard size radios
Two (2) strips- Icom and Uniden
Three (3) strips- GME Electraphone

Microphone and Microphone Cable Holder installation:

Install in a position that suits best, depending on vehicle and Radio model. Ensure microphone or microphone cable and holder does not foul on sun visor when pulled down.



Microphone clip on slight angle



Left hand cable outlet radios



Microphone clip on acute angle