

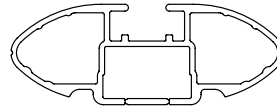

DK144 Rhino-Rack VA, Euro & HD crossbar instruction

IDENTIFICATION CHART



VA crossbar

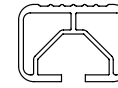

EURO crossbar

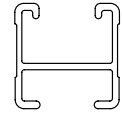

HD crossbar

			FRONT CROSSBAR											
Vehicle	Date	Crossbar	Front Right Pad/Clamp	Front Left Pad/Clamp	Measurement strip length per side	Measurement strip length per side	Measurement Distance (x)	Foot plate arrow direction			Measurement strip length per side	Measurement strip length per side	Measurement Distance (x)	Foot plate arrow direction
Great Wall V200 Dual Cab utility	11-15	1260mm	M367 SUB0246	M367 SUB0246	151mm	38mm	950mm / 37,13/32"	OUT	M367 SUB0246	M367 SUB0246	142mm	29mm	932mm / 36,11/16"	OUT
			Arrow FORWARD						Arrow FORWARD					
Great Wall V240 Dual Cab utility	09-15	1260mm	M367 SUB0246	M367 SUB0246	151mm	38mm	950mm / 37,13/32"	OUT	M367 SUB0246	M367 SUB0246	142mm	29mm	932mm / 36,11/16"	OUT
			Arrow FORWARD						Arrow FORWARD					



DK144 Rhino-Rack VA, Euro & HD crossbar instruction

Measurement A: CENTRE of door jamb to CENTRE arrow of leg foot plate.

Measurement B: CENTRE of Front leg foot plate arrow to CENTRE of Rear leg foot plate arrow.

Carrying capacity: Roof rack is rated to 75kg. Please refer to manufacturers handbook for your vehicles maximum roof load capacity. Always use the lower of the two figures.

If your vehicle is not listed on this fitting instruction please refer to your countries Rhino-Rack web site for the latest information.

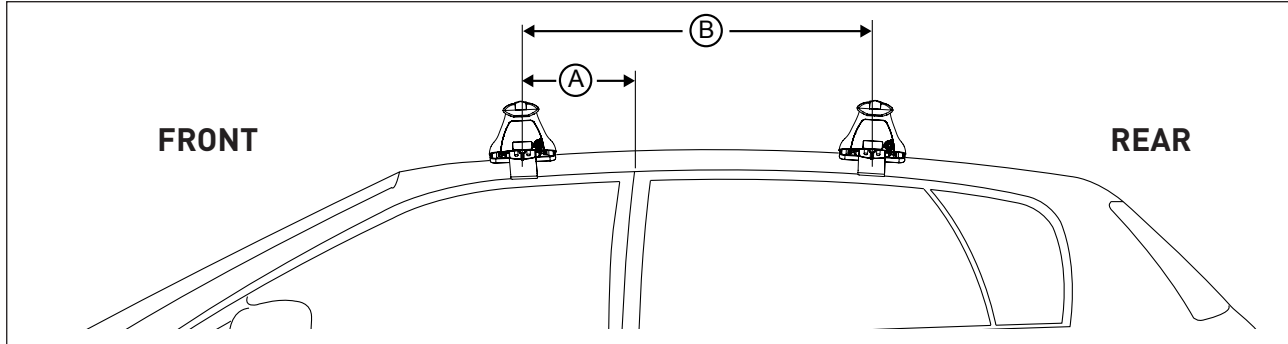
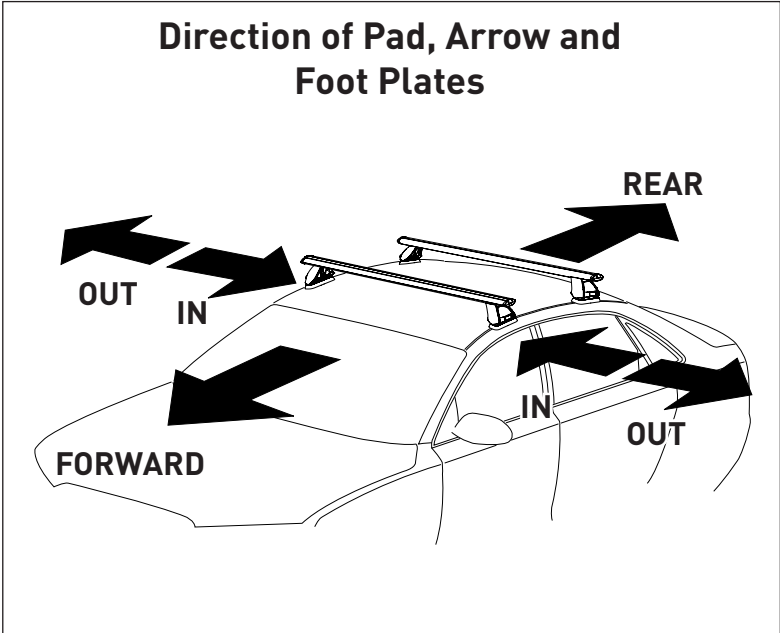
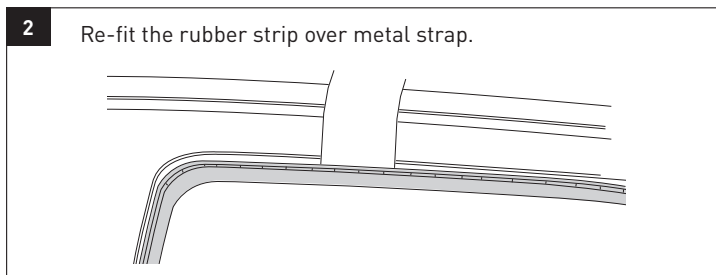
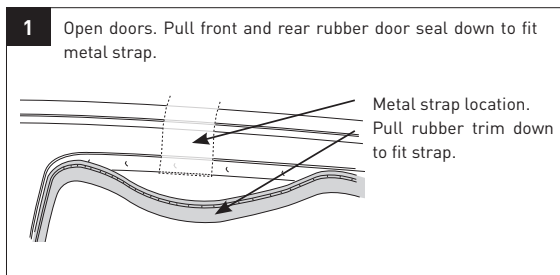

VEHICLE	Date	Measurement A	Measurement B	Load Rating (includes racks 5kg/ 11lbs)
Great Wall V200 Dual Cab utility	11 - 15	220mm / 8,21/32"	700mm / 27,9/16"	Up to* 75kg / 165lbs
Great Wall V240 Dual Cab utility	09 - 15	220mm / 8,21/32"	700mm / 27,9/16"	Up to* 75kg / 165lbs

*System Load Rating: Please refer to manufacturer's handbook for your vehicle's maximum roof load capacity. Always use the lower of the two figures.