

PIRANHA OFFROAD PRODUCTS P/N BTPRAP07

'Piranha Off Road products are not associated in any way with Toyota Australia or any of its related companies'

To Suit PRADO 120 SERIES
4L PETROL

PART NUMBER	BTPRAP07
APPROX FITTING TIME	2 Hour
MAX BATTERY SIZE	300mm L
MAX BATT WEIGHT	23Kg
CYCLE DUTY	
TRAY LOCATION	DSF

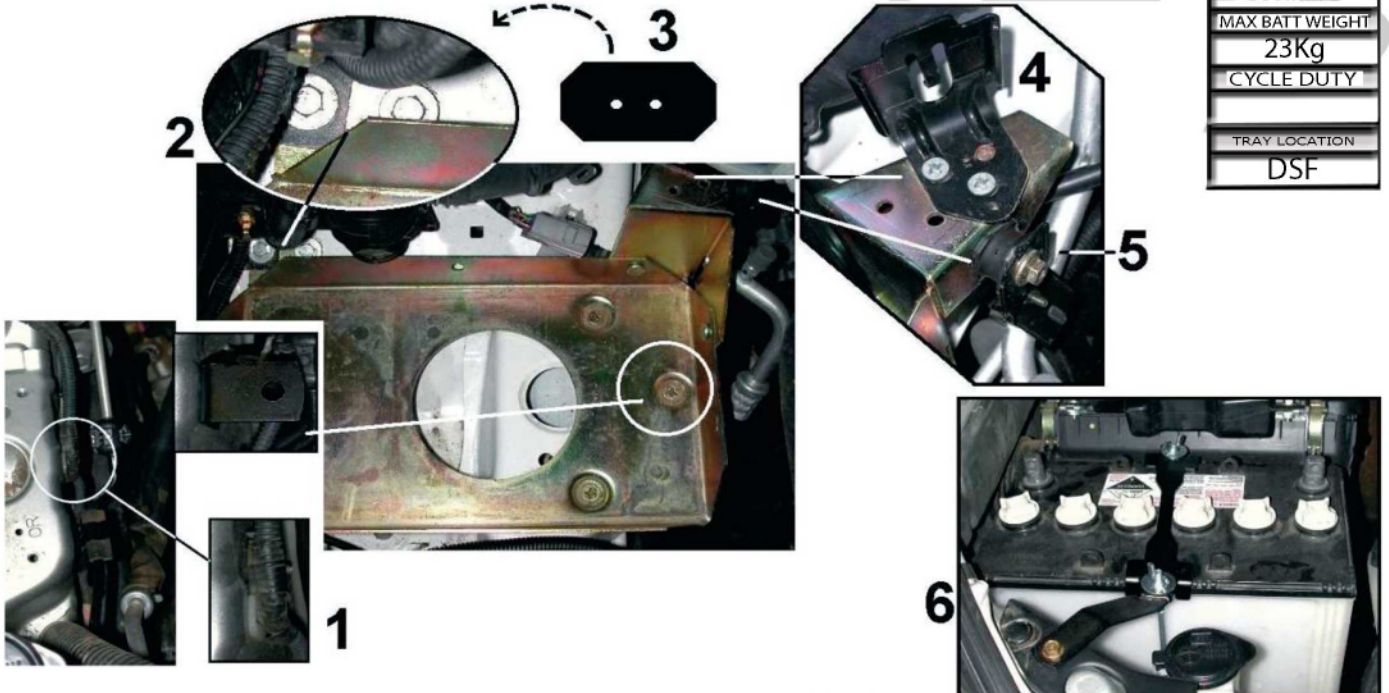

FITTING INSTRUCTIONS

The cradle fit drivers side front.

Bolt supplied Power Steering Bracket to outer top right hand corner of Battery Tray using 2 x M6 weld bolts.

Remove metal bracket on air cleaner duct, retain 2xM6 short bolts. Remount small earth strap out of the way, and remove small bracket holding Air conditioner pipe, separate and retain rubber mounting block to be used later.

Unbolt power steering reservoir bracket, drill out the three (3) spot welds on bracket and keep the slide section holding the reservoir this remounts to new bracket at a later stage.

Pass the Power Steering reservoir, with hoses connected under and over the Air conditioner pipe, the hoses now run over the air con pipe not under.

Unclip wiring loom and bolt in supplied right angle bracket using 1xM6 bolt and nut (Pic 1).

Unbolt junction of earth wires from inner guard, discard bolt.

Fit the tray in position and using three (3) counter sunk M6 bolts, using long M6 bolt and washer replace earth strap junction together with Battery Tray arm to inner guard. Drill 2xM6 holes through the mount on tray and through the wheel arch. Mount new air cleaner duct bracket, supplied, reusing the short M6bolts. Using 2xM6 nuts and bolts, bolt through the air cleaner duct bracket, the tray mount, the wheel arch and the support plate on the under side of the wheel arch (Pic 2+3).

Mount the Air Conditioner pipe to the side of the new Power Steering bracket using rubber mounting block (Pic 5).

Sit battery in position, slide Power Steering bracket onto Power Steering reservoir, position reservoir and mark the 3x holes to be drilled out. **IMPORTANT:** ensure that battery does not rub on reservoir.

Remove battery drill out holes to mount Power Steering bracket and secure with 3xM6 weld bolts and nuts (Pic 4)

Replace battery install supplied top mount, drill through the "4" stamped into the metal of the radiator support, DO NOT follow through drilling or you WILL damage the headlight. Secure top mount with M6 bolt (Pic 6)

Addition bracket mounts to tray for Air Conditioner line. This is for 2007 model onwards (Pic 7)

Ensure, before closing the bonnet that all items fitted have adequate clearance

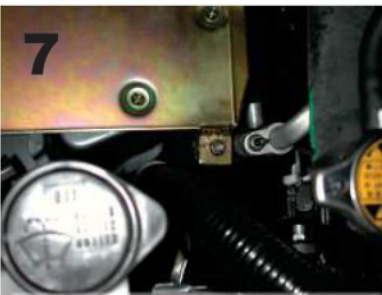

PARTS INCLUDED WITH TRAY

- 1 X Tray
- 1 X Tray Support Bracket
- 1 X Support plate
- 6X M6 Nut
- 3 X M6 Bolt
- 1 X Special top Mount
- 5 X M6 Bolt Countersunk
- 1 X Washer
- 1 X M6 Long Bolt
- 2 X J Bolt
- 5 X Weld Bolt
- 1 X Power Steering - Reservoir Bracket
- 1 X Air Intake Mount
- 1 X Air Pipe Bracket

RECOMMENDED ISOLATOR

**DBE140SF
or
DBE180-SX**