

DO NOT PRINT THIS PAGE

Printing Notes:

Material: 80 GSM Bond Paper or 50# Bond Paper White

Ink: Black

Resolution: 150 DPI or above

Printing method: Offset Printing

Binding: Saddle Stitch

Folded size: 210 x 285 mm (W x H)

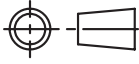
This drawing contains proprietary information and trade secrets of The Furrion Company, Inc. Unauthorized use or copying is prohibited.							
METRIC [INCH]							
METRIC [INCH]							
CRITICAL DIMENSION CHECKING IS COMPULSORY							
VOLUME	cm ³	V1.0	18-Oct-22	NEW	Grace Sun	XX	
MASS	grams	REV.	DATE	MODIFICATIONS	NAME	ECN NO.	
DENSITY	g/cm ³	MATERIAL: SEE NOTES		Furrion Property Holding Ltd			
GENERAL TOLERANCES EXCEPT AS NOTED 0 TO 6mm = ±0.1 >6 TO 30mm = ±0.2 >30 TO 80mm = ±0.3 >80 TO 180mm = ±0.4 >180mm = ±0.5 ANGULAR = ± 3°		FINISH SPEC: SEE NOTES		COMPOSITE-NO	SHEET 1 OF 1		
		SCALE: 1:1	DATE: 18-Oct-22	DRAWN BY: Grace Sun	APPROVED BY: Mandy Tse	REVISION 1.0	
		NAME: IM for Low Cost Trim Kit Rooftop Air Conditioner - Electronic				PART NO. IM-FHA00124	

9K & 12K BTU ROOFTOP AIR CONDITIONER

FACR09SM-PS[2021132274]; FACR12SM-PS[2022107892];
FACTRCM-PS[2021132281];

USER MANUAL



Product picture for reference only

CONTENTS

OVERVIEW	2
Safety Instructions.....	2
Important Installation Requirements	2
Introduction	2
User Guide.....	2
Technical data.....	3
INSTALLATION.....	3
Precautions.....	3
Installation Position	3
Preparation for Installation.....	4
System Wiring.....	6
CONTROL INSTRUCTIONS.....	8
Remote Control.....	8
Install/Replace the Remote Control Batteries	10
Display at the air distribution box.....	10
MAINTENANCE OF AIR CONDITIONER.....	11
Cleaning of Filter Screen	11
Panel Surface Cleaning.....	11
TROUBLESHOOTING	11
ERROR CODE OF DISPLAY BOARD.....	11
CIRCUIT DIAGRAM OF OUTDOOR UNIT AND PANEL.....	12
INSTALLATION EXPLODED DRAWING.....	12

OVERVIEW

Safety Instructions

This manual contains important information to guarantee correct use of the air conditioner. Include this manual when you pass on the air conditioner to another person.

⚠ DANGER

This is a safety warning sign. When you see this sign in this manual, the corresponding contents may cause personal injury, so you must follow the recommended preventive measures and safe operation instructions.

⚠ WARNING

Indicate a potentially dangerous situation that may lead to death or serious injury.

⚠ NOTE

Indicate a potentially dangerous situation, which may lead to minor or moderate injury.

⚠ CAUTION

Indicate a potentially dangerous situation, which may cause property damage.

Important Installation Requirements

- The air conditioner can only be installed horizontally on the top of the Caravan / Recreational Vehicle (RV).
- The minimum spacing between trusses on the roof structure is 15 3/4" (400mm).
- The minimum thickness of the roof of RV is 1" (26mm) and the maximum thickness is 3 7/8" (100mm).
- When the roof thickness is greater than 3 7/8" (100mm), additional air ducting hoses are required for connection.

Introduction

This air conditioner is for use in Caravan / Recreational Vehicle (RV), motor homes, etc. It will cool or heat the interior of the camper to the desired/optimal temperature. When the weather is hot it supplies cool and dehumidified air and when the weather is cold it supplies hot air.

User Guide

⚠ WARNING

- This appliance is not intended for use by persons (including children) with reduced physical, sensory or mental capabilities, or lack of experience and knowledge, unless they have been given supervision or instruction concerning use of the appliance by a person responsible for their safety.
- Children should be supervised to ensure that they do not play with the appliance.

The heating and cooling performance of this air conditioner is influenced by many external factors, i.e. the insulation materials used, the size and type of windows, etc. By taking the following precautions you can improve the overall performance:

- Park the RV in a cool place / in an area with lots of shadow.
- Improve the vehicle's heat insulation by eliminating openings and covering the glass surface with reflecting curtains.
- Close doors and windows or avoid frequent opening and closing of them.
- Avoid using heating devices inside the vehicle. Turn on the air conditioner in advance to and use high fan speed mode to achieve a faster cooldown.

NOTE: Depending on the weather and humidity, you may get water droplets on the ceiling around the air duct outlets. This is caused due to condensation effects and is not a malfunction of the unit. To reduce condensing water to appear, it is recommended to close all door and windows and consider to lower the fan speed. The condensing water will reduce after a while of using the air conditioner.

The manufacturer will not be responsible for any damage arising from condensation on the ceiling or the surface of other objects caused by the condensate of this product.

Technical data

	FACR09SM-PS	FACR12SM-PS
Rated cooling capacity	2637W	3516W
Rated heating capacity	2784W	3663W
Input supply voltage	220-240 V(AC)/ 50Hz	
Input current rating	4.2A (nominal)	5.5A (nominal)
	22.5A (locked rotor)	28A (locked rotor)
Input power (Cooling)	1000W	1300W
Input power (Heating)	800W	1060W
Maximum outlet airflow	490m ³ /h	480m ³ /h
Refrigerant (R 410 A)	620g	740g
Protection class	IP X5	
Operating temperature	From -7 °C to +43 °C	

NOTE:

- Installation and repair of the air conditioner must only be carried out by qualified personnel who are familiar with the risks involved and the relevant regulations. Inadequate repairs may cause serious hazards. Ensure the unit is connected to a proper fused circuit / ground leakage breaker.

INSTALLATION

Precautions

Please read the installation and operation instructions carefully before the installation and use of this product. The manufacturer will not be liable for any loss or injury caused by not following the steps as given in this manual.

- The installation must comply with national electrical codes regulations or industry standards.
- Without manufacturer's authorization, this product shall not be equipped with any equipment or accessory.

This product must be installed and repaired by qualified personnel.

Installation Position

Preparation for Installation

This product is installed on the roof RV. When determining your cooling requirements, the following points should be considered:

- Size of RV.
- Window area of RV (the larger the area, the more hot the RV gets).
- Thickness and thermal insulation performance of insulating materials of the RV.

Selection of Installation Position:

This product shall be installed in the place of an existing roof vent or in an area which has been constructed to carry the weight of an air conditioner.

There must be an opening with the size of 14 1/4" x 14 1/4" ±1/4" (362 x 362mm ±3mm).

When there is no existing opening on the roof or this air conditioner needs to be installed in other positions, it is recommended to take the following measures:

- For the installation of a single air conditioner, the air conditioner should be installed at a position slightly ahead of the center point (as viewed from the head of the vehicle) and in the middle sideways. Refer to following illustration:

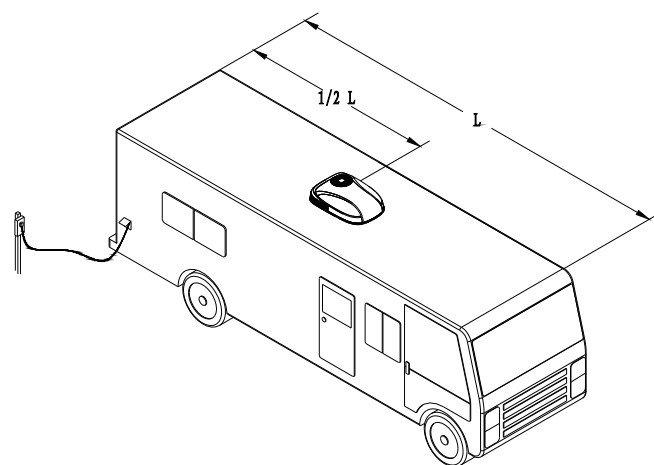

- For the installation of two air conditioners, the air conditioners should be installed at 1/3 and 2/3 positions away from the front end of RV respectively, and at the middle sideways. Refer to following illustration:

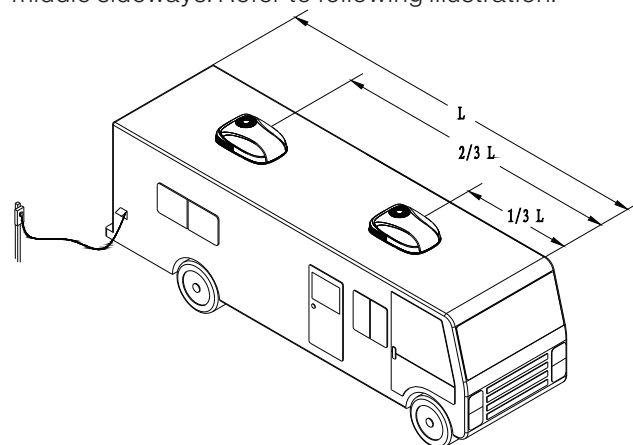

- The rooftop unit shall be installed leveled (maximum inclination permitted: 15 degrees).
- After the installation position is determined, it is required to check whether there are obstacles in the installation area, and the distance between the back of vehicle body and other roof equipment should be at least 18" (457mm).
- When the RV is moving, the top must be able to support heavy objects weighing 60kg. Generally, the static load

design of 100kg can meet this requirement.

- Check whether there are obstacles (i.e., door openings, partition frames, curtains, ceiling fixtures, etc.) that hinder the installation of inner panel of the air conditioner.
- The rooftop unit and the air distribution box are as following:

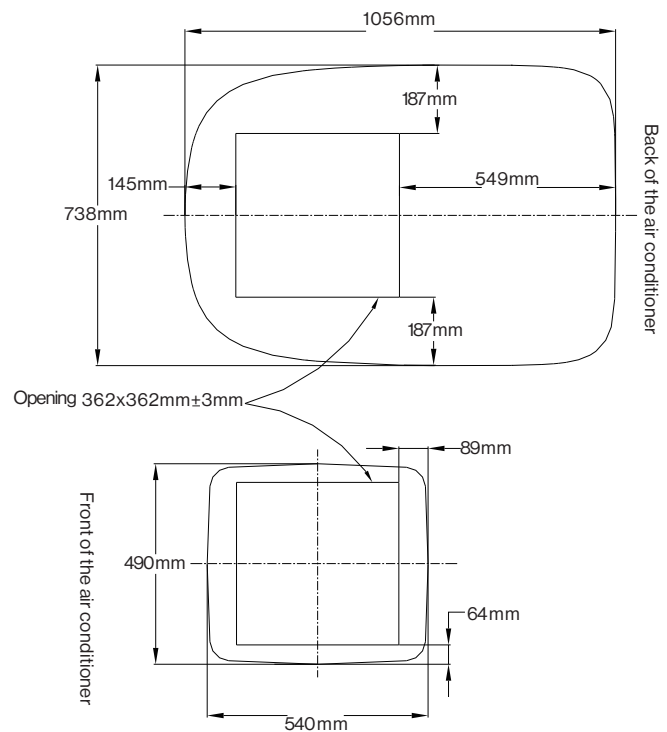
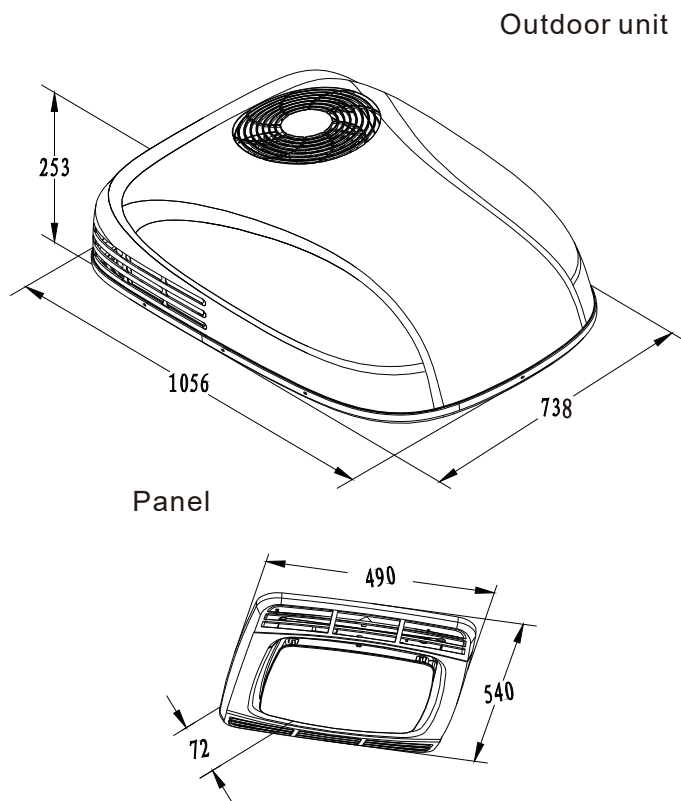

Preparation for Installation

Installing in an Existing Opening

1. Unscrew and remove the roof vent.
2. Remove all caulking compound around the opening.
3. If the opening exceeds $14\frac{3}{4}'' \times 14\frac{3}{4}''$ ($375 \times 375\text{mm}$), it will be necessary to resize the opening to $14\frac{1}{4}'' \times 14\frac{1}{4}''$ ($\pm\frac{1}{2}''$) [$362 \times 362\text{mm}(\pm 12.7\text{mm})$]. If the opening is less than $13\frac{3}{4}'' \times 13\frac{3}{4}''$ ($349 \times 349\text{mm}$), it must be enlarged.

New Roof Opening

Cut a $14\frac{1}{4}'' \times 14\frac{1}{4}'' + \frac{1}{8}''$ ($362 \times 362\text{mm} + 3\text{mm}$) opening on the roof of RV, which must be located between the roof reinforcements and must pass through the roof and ceiling of the RV.

⚠ WARNING

There might be existing high and low voltage wiring in the ceiling construction. Shut off the mains battery switch and disconnect the RV from the shore power outlet. Failure to follow this instruction may result in electric shock and further cause death and personal injury.

- Mark a $14\frac{1}{4}'' \times 14\frac{1}{4}'' \pm \frac{1}{8}''$ ($362 \times 362\text{mm} \pm 3\text{mm}$) square on the roof and cut the square hole carefully;
- Cut a matching hole on the ceiling based on the roof opening as shown in the following figure. (There should be no obstacle within a minimum distance of 18" (457mm) to the back of vehicle body).

Notes for Hole Opening

- If the opening exceeds $14\frac{3}{8}'' \times 14\frac{3}{8}''$ ($365 \times 365\text{mm}$), gaskets must be installed.
- If the opening exceeds $14\frac{1}{8}'' \times 14\frac{1}{8}''$ ($358 \times 358\text{mm}$), the opening must be enlarged.

Wiring Requirements

- The wiring method must comply with all national wiring regulations.
- Ensure that the wire extends into the roof opening by at least $14\frac{15}{16}''$ (380mm), which can facilitate the installation of air conditioning equipment;
- In case a vent fan has been removed, stow away any existing wiring in a safe manner.
- Ensure sheathing of wire is not getting damages by any sharp corners/edges/penetrations.

Reinforcement at cutout

- The opening must be adequately supported, and the roof inner structure should be filled with insulating materials. To prevent resonance caused by air in the roof structure, it is required to seal the periphery with battens with a thickness of $\frac{3}{4}''$ (20mm) or more, and provide a wire inlet for the power line as shown in the following figure:

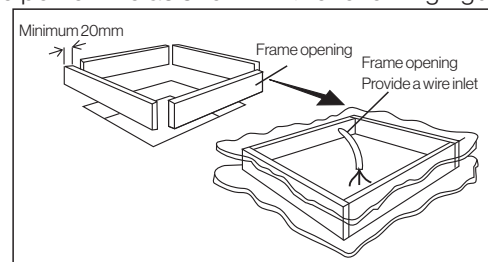

- The $14\frac{1}{4}'' \times 14\frac{1}{4}'' \pm \frac{1}{8}''$ ($362 \times 362\text{mm} \pm 3\text{mm}$) roof opening is an integral part of the return air duct and must be polished according to industry standards.

⚠ NOTE

The installation personnel of air conditioning equipment shall be responsible for ensuring structural integrity of the roof of RV. Do not create a low-lying place where water will accumulate on the roof. Otherwise, stagnant water around may seep into the vehicle, causing damage to this product and RV.

Placement of Air Conditioner on the Roof

⚠ NOTE

The heaviest outdoor unit of this product weighs about 45Kg. To prevent damage to the air conditioning equipment, please lift this product to the roof with a crane.

- Take out the outdoor unit of air conditioner in the carton.
- Place the outdoor unit of air conditioner on the roof.
- Lift the equipment (do not drag it) based on the box sponge of air conditioner, and place it above the prepared opening with the condenser coil facing the rear of RV, as shown in the following figure:

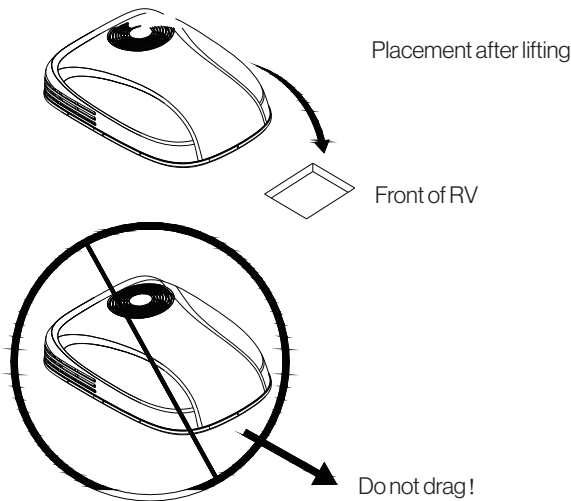

⚠ NOTE

Do not drag the air conditioner, otherwise the sealing / noise damping foam on the bottom of the rooftop unit gets damaged. Failure to comply could lead to water ingress into the RV.

- Install the air distribution box frame. This frame will fasten down the rooftop unit. Refer to following figure:

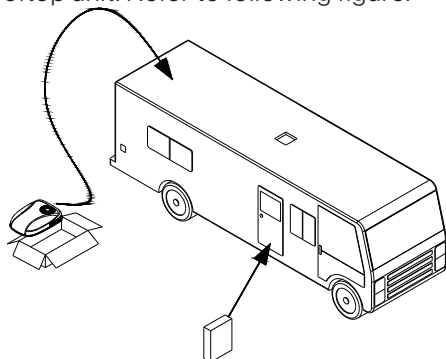

Note: All cardboards should be recycled

- In case any deviation is found at the position of outdoor unit on the roof during the installation of the frame, replace the rooftop unit (the sponge on the rooftop unit must be aligned with the 14 1/8" x 14 1/8" (362x362mm) square hole).

Installation of Air Duct and Top Fixing Plate

1. Take out all the parts from the air distribution carton box.
2. Reach into the return air inlet of the rooftop unit and pull down the wire harness of outdoor unit of the air conditioner (heat pump model also has four-way valve connecting wire and sensor lead, and electric heating model also has electric heating connecting wire) for the convenience of subsequent connection, as shown in the following figure:

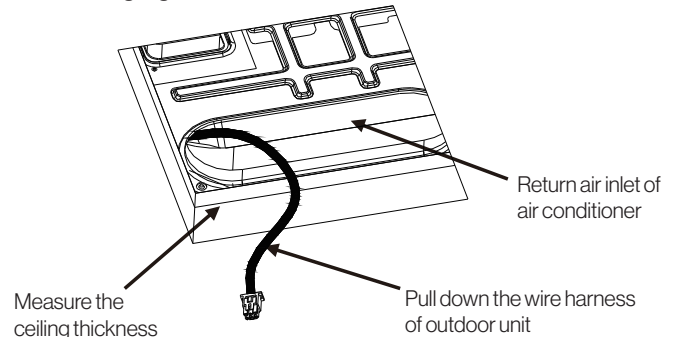

3. Measure the thickness from ceiling to roof to select the appropriate air duct sponge:
 - The air divider sponge comes in 3 different heights 9/16" (15mm), 1 3/16" (30mm) and 1 3/4" (45mm)]
 - NOTE:** Remove the supporting at the middle section of the air divider sponge
 - If the distance is 1" - 1 3/16" (26-30mm), choose the air duct sponge with a thickness of 9/16" (15mm);
 - If the distance is 1 3/16" - 1 9/16" (30-40mm), choose the air duct sponge with a thickness of 1 3/16" (30mm);
 - If the distance is 1 9/16" - 2 3/8" (40-60mm), choose the air duct sponge with a thickness of 1 3/4" (45mm);
 - If the distance is greater than 60mm, the air duct sponges with a thicknesses of 9/16" (15mm), 1 3/16" (30mm) and 1 3/4" (45mm) shall be used in a combined manner according to the actual situation;
 - If the distance is greater than 3 15/16" (100mm), an optional pipe joint should be used.

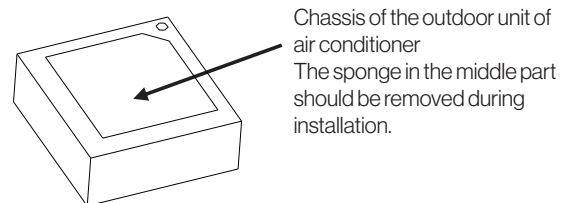

4. Select the correct air duct sponge, remove the middle part, and paste it on the air distribution box frame along the air outlet (align sponge with opening), as shown in the following figure:

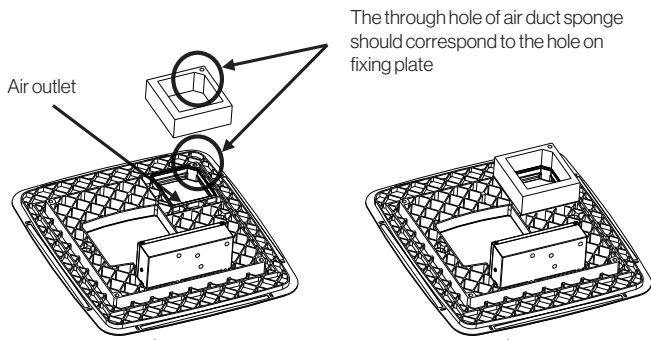

5. Ensure the arrow on the mounting frame points towards the front of the RV. Use the 4 long mounting bolts to tighten down the rooftop unit.

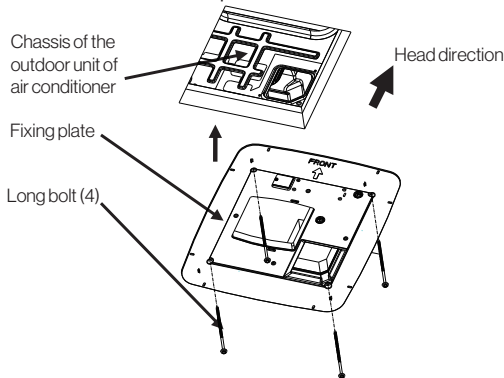

Note: Before tightening the long bolts, screw each bolt by hand at first. The four rivet nuts on the chassis of the rooftop unit are located at four corners of the opening. Screw the 4 long bolts into the corresponding rivet nuts by hand, and then tighten them evenly one by one with a torque of 4.5N.m-5.5N.m, so that the thickness of box sponge on the roof will be compressed to about 1/2" (13mm). The bolts are self-locking bolts, so there is no need to tighten them excessively.

NOTE

If the bolts are loose, the roof may not be sealed sufficiently. If the bolts are tightened excessively, the chassis of air conditioner or fixing plate may be damaged. Please tighten them according to the torque specification listed in this manual.

System Wiring

WARNING

1. Disconnect RV from shorepower and shut off battery mains switch. Failure to comply with these instructions will result in electric shock hazard and further cause death or serious injury.
2. The metal parts of the rooftop unit are all connected to the protective ground terminal to prevent electric shock hazard. Please ensure that the equipment has been connected to a 220-240V/50Hz circuit with reliable grounding. Failure to follow the above instructions will result in death, injury or equipment damage.

IMPORTANT: Electrical installation must be carried out by professionals, and wiring must be conducted in accordance with national electrical codes and industry standards.

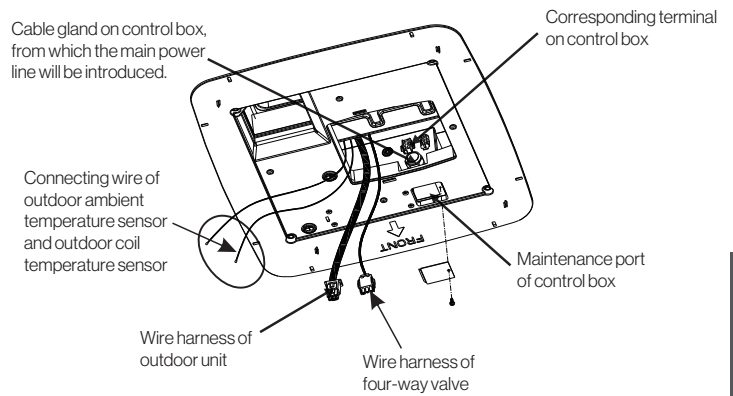

1. Remove the plate of the maintenance port on the control box. Feed through strain relief the mains power cable [let it overhang for about 5 15/16" (150mm)]. The strain relief needs to be tightened to prevent the main power line from being pulled and causing the connection to become loose.
2. Connect the white wire in the control box to the white wire(neutral) of the main power line, the black wire to the black wire(live) of the main power line, and the yellow-green wire to the yellow-green wire(protective earth) the main power line. All wires are recommended to be connected by special wiring terminals, which must be connected well and firmly.
3. Put the connected wires back into the maintenance port of control box, and affix the cover plate back. Connect all the wires from the rooftop unit to the control box. Ensure all plugs are fully inserted / pushed in.
4. Available wire harnesses - refer to following diagram for details:

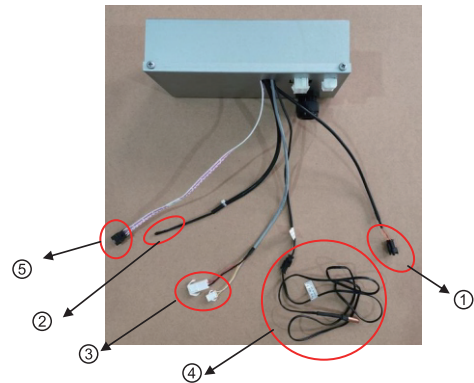

- ① Connecting wire of display panel;
- ② Room temperature sensor;
- ③ Outdoor ambient temperature sensor and outdoor coil temperature sensor;
- ④ Anti-freezing sensor;
- ⑤ LED strip connecting wire(optional);

5. Insert the anti-freezing temperature sensor into plastic bracket located on the evaporator, as shown in the following figure:

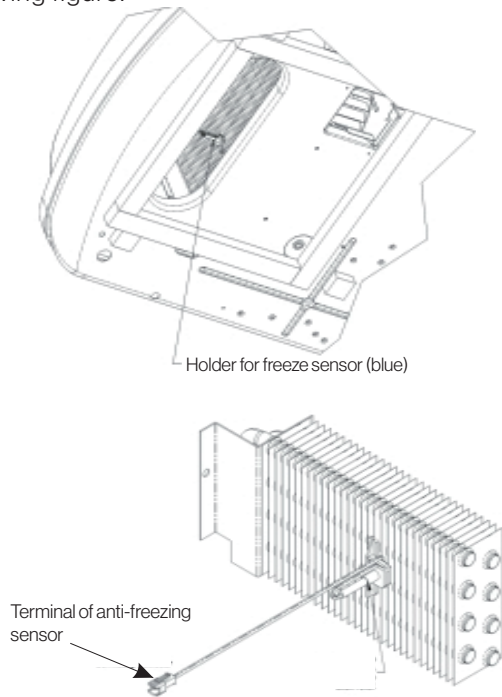

Panel Installation

1. Press the left and right buckles on the decorative panel at the same time to remove the decorative panel, as shown in the following figure:

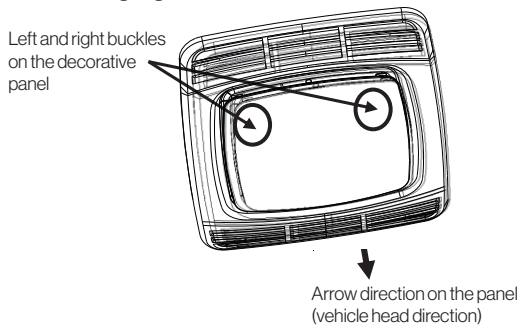

2. Take out the panel, place it according to the direction indicated on the panel, pass the connecting wire of display panel on the control box through the via hole on the panel, install the panel on the fixing plate and fix it tightly with 4 screws, as shown in the following figure:

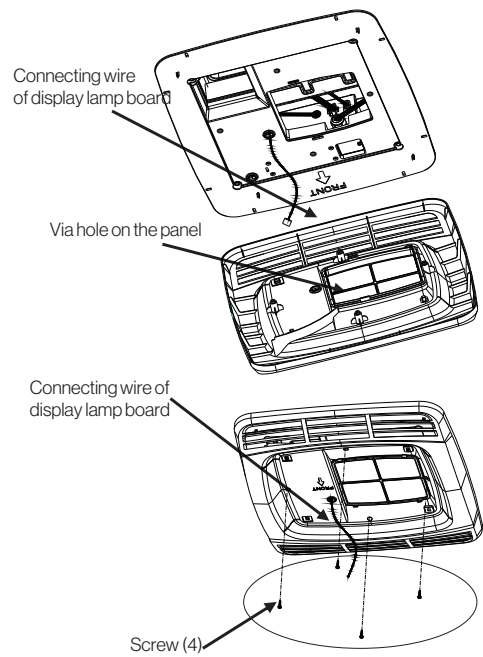

3. Take out the decorative panel, ensure the arrow faces towards the front of the TV, and connect the lamp board wires as shown below. Be careful when attaching the decorative plate - first insert at buckles.

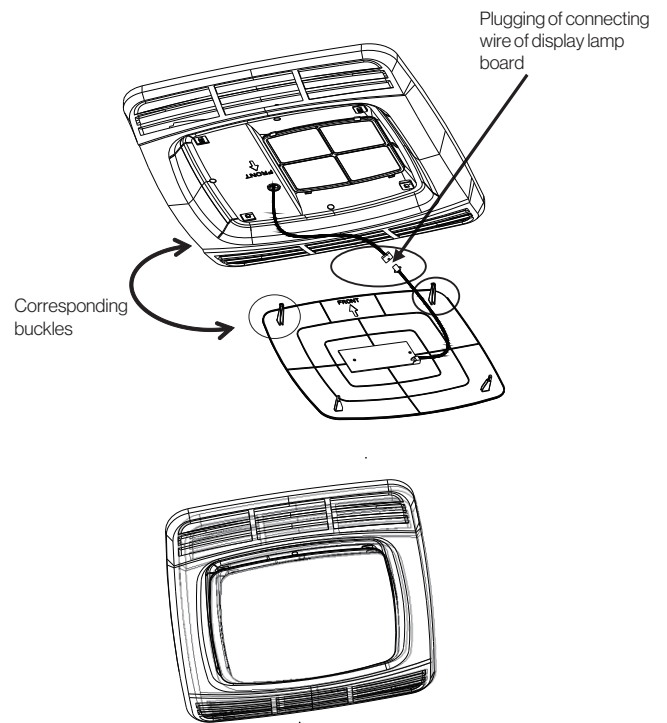

4. After the air conditioning equipment is installed, turn on the power supply and perform an inspection / functional check. Before continuing the operation, read operation instructions of the equipment.

CONTROL INSTRUCTIONS

Remote Control

Press the **"MODE"** button to switch between various modes (Auto, Cooling, Dry, Fan, and Heating), the system will confirm the selected working mode after 2 seconds, and internal buzzer sound can be heard. During operation, the remote controller should be aimed towards the air distribution box for optimal reception.

Note: The compressor may not turn on immediately after a mode is selected. It may take up to 3 minutes.

Introduction of LCD icons

Icons	Meaning	Icons	Meaning
	Auto		Fan speed
	Cooling		Sleep
	Dry		Auto fan
	Fan		Temp
	Heating		Clock
	Electrical Heat(not applicable for this model)		Timer
	Lock		

Remote control functions

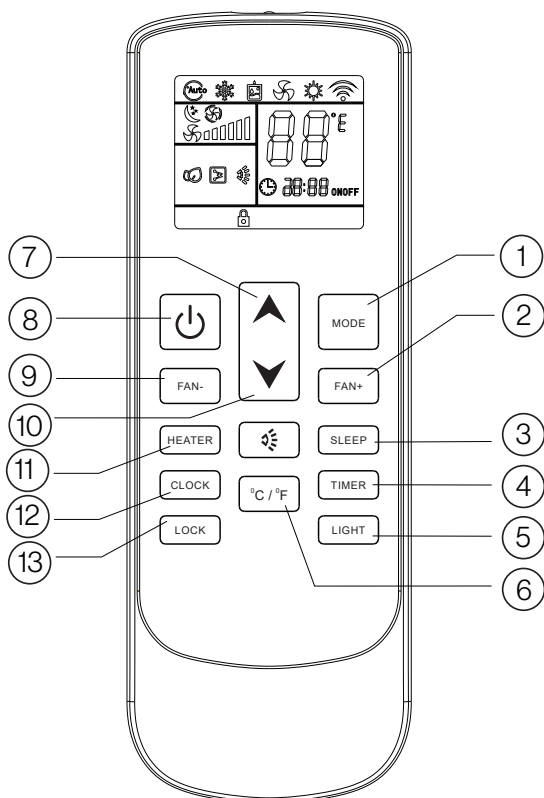

NO.	BUTTON	FUNCTION
①	MODE	Set the air conditioner operating mode.
②	FAN+	Increase the fan speed.
③	SLEEP	Enter sleep mode, and the ambient temperature will be regulated automatically.
④	TIMER	Set or cancel the timer function.
⑤	LIGHT	Turn on or turn off the light.
⑥	°C / °F	Switch the temperature unit between Celsius (°C) and Fahrenheit (°F)
⑦	▲	Increase the temperature/time.
⑧	⏻	Turn on or turn off the air conditioner.
⑨	FAN-	Decrease the fan speed.
⑩	▼	Decrease the temperature/time.
⑪	HEATER	Not applicable for this model.
⑫	CLOCK	Adjust the clock.
⑬	LOCK	Lock the remote control set.

Heating mode

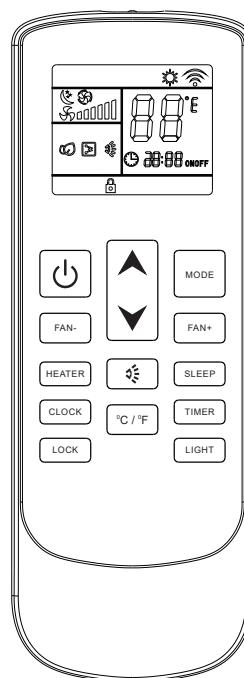

- Press the button to turn on the air conditioner.
- Press the **MODE** button to select heating mode.
- Press **UP ▲** or **DOWN ▼** button to set the desired temperature.
- Press the **FAN+** or **FAN-** button to set the fan speed:
 : Low speed
 : Medium speed
 : High speed
 : Auto speed
NOTE: In auto setting, the speed is chosen automatically based on the difference between room temperature and set temperature(the bigger the difference, the faster the fan will run).
- Press the button to switch off the air conditioner.

Cooling mode

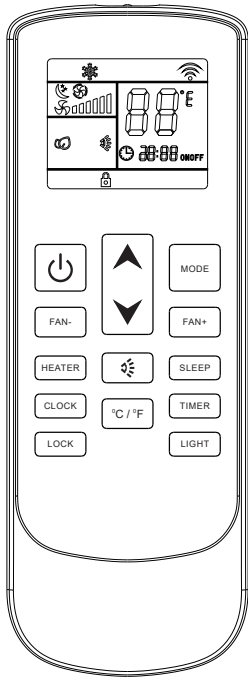

- 1** Press the ϕ button to turn on the air conditioner.
- 2** Press the **MODE** button to select cooling ❄️ mode.
- 3** Press **UP ▲** or **DOWN ▼** button to set the desired temperature.
- 4** Press the **FAN+** or **FAN-** button to set the fan speed:
 "❄️": Low speed
 "❄️❄️": Medium speed
 "❄️❄️❄️": High speed
 "❄️": Auto speed
NOTE: In auto setting, the speed is chosen automatically based on the difference between room temperature and set temperature (the bigger the difference, the faster the fan will run).
- 5** Press the ϕ button to switch off the air conditioner.

Fan mode

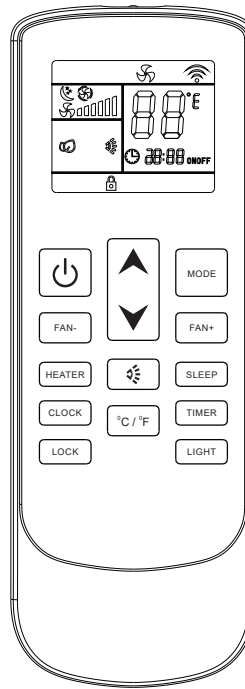

- 1** Press the ϕ button to turn on the air conditioner.
- 2** Press the **MODE** button to select fan 🌀 mode.
- 3** Press the **FAN+** or **FAN-** button to set the fan speed:
 "🌀": Low speed
 "🌀🌀": Medium speed
 "🌀🌀🌀": High speed
- 4** Press the ϕ button to switch off the air conditioner.

Dry mode

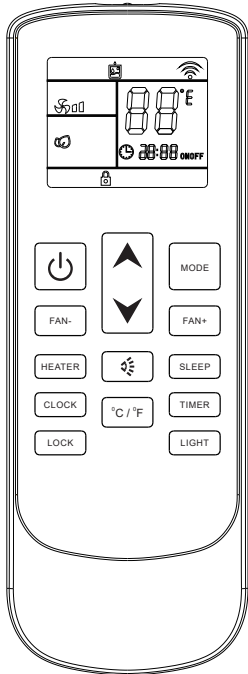

- 1** Press the ϕ button to turn on the air conditioner.
- 2** Press the **MODE** button to select dry ☁️ mode.
- 3** Press **UP ▲** or **DOWN ▼** button to set the desired temperature.
- 4** Press the ϕ button to switch off the air conditioner.

NOTE: In dry mode, the fan speed will be set to the low speed and it cannot be changed.

Sleep mode

The sleep mode regulates the temperature so as to keep you comfortable through the different stages of your sleep. In sleep mode, the air conditioner unit will regulate the ambient temperature automatically so that you don't feel too cold and consume too much power.

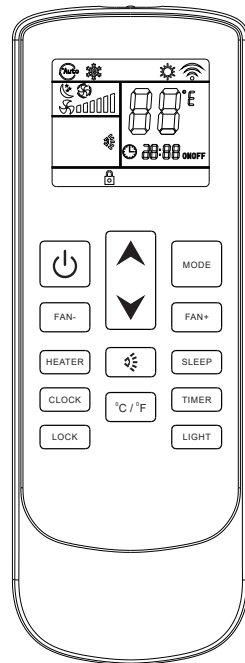

- 1** Press the ϕ button to turn on the air conditioner.
- 2** Press the **MODE** button to select the desired mode to cool ❄️ /heat 🔥 (heat pump)/auto 🌀 , the air conditioner will run in set mode.
- 3** Press **SLEEP** button to turn on sleep mode.
- 4** Press **UP ▲** or **DOWN ▼** button to set the desired temperature.
- 5** In sleep mode, press the **SLEEP** button once, the SLEEP icon 🌙 will be displayed on the LCD, press again to exit sleep mode.

NOTE: The fan will be running in low fan speed in sleep mode.

Auto mode

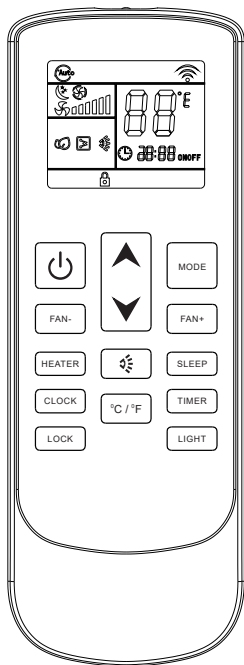

- 1** Press the button to turn on the air conditioner.
- 2** Press the **MODE** button to select auto mode.
- 3** Press the **FAN+** or **FAN-** button to set the fan speed:
 "🌀": Low speed
 "🌀🌀": Middle speed
 "🌀🌀🌀": High speed
 "🌀🌀🌀🌀": Auto speed
NOTE: In auto setting, the speed is chosen automatically based on the difference between room temperature and set temperature (the bigger the difference, the faster the fan will run).
- 4** Press the button to switch off the air conditioner.

NOTE: In auto mode, the unit will choose to run in cool/heat/fan mode automatically based on the temperature of the RV.

- When the room temperature ≤ 20 °C, the unit will run in heat mode.
- When the room temperature is between 20 °C and 25 °C, the unit will run in fan mode.
- When the room temperature ≥ 25 °C, the unit will run in cool mode.

Timer Function

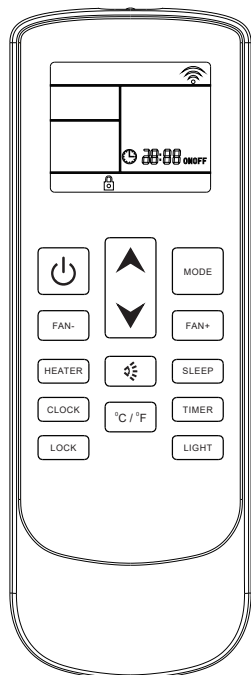

- Timer ON**
When the air conditioner is switched off, press the **TIMER** button to turn on the air conditioner automatically at the set time.
- 1** Press the button to set the hour and press the button to set the minute.
 - 2** Set the air conditioner operating mode, temperature, fan speed etc.

The air conditioner will be turned on automatically at the set time.
NOTE: If the **TIMER** button is pressed again, the timer on setting will be canceled.

- Timer OFF**
When the air conditioner is running, press the **TIMER** button to turn off the air conditioner automatically at the set time.

- 1** Set the switch off time by pressing the button to set the hour and press the button to set the minute.

Install/Replace the Remote Control Batteries

1. Remove the battery compartment cover.
2. Install two AAA batteries (supplied). Ensure batteries are inserted with the proper polarity.
3. Replace the battery compartment cover.

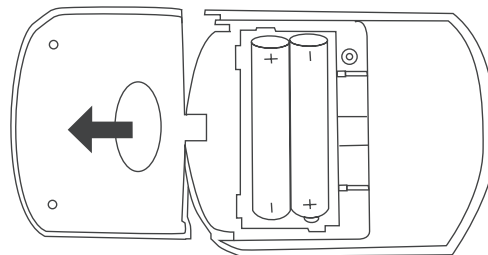

Display at the air distribution box

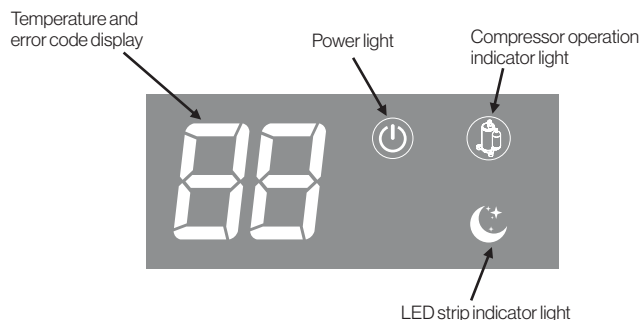

- Temperature and error code display:** used to set the display of temperature, room temperature and error code.
Power light: when the air conditioner is started up, the power light will be on. When it's shut down, the power light will go out.
Compressor operation indicator light: it will be on when the compressor is turned on, and go out when the compressor is turned off.
ON/OFF button: it's on the display board, used to start up/shut down the air conditioner when the remote controller is lost.

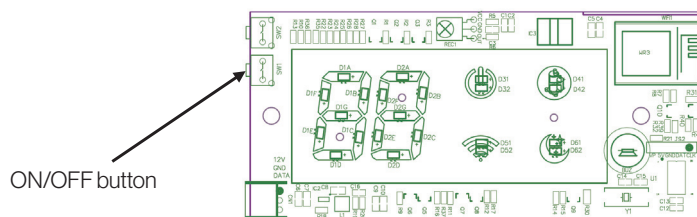

MAINTENANCE OF AIR CONDITIONER

Cleaning of Filter Screen

Position of left and right buckles of the decorative panel
Regularly remove the filter screen behind the decorative panel inside the panel (press the left and right buckles of the decorative panel, and the decorative panel can be removed), and rinse it, clean it with clear water, dry it and reinstall it.

NOTE: It is not allowed to operate the air conditioner without the filter screen, otherwise, the evaporator coil will be defiled and the service life of air conditioner will be affected.

Panel Surface Cleaning

Clean the outer surface of the panel with soft cloth dipped in neutral detergent. Do not use polishing or cleaning powder.

Fan Motor

The fan motor has been lubricated before leaving the factory and does not need special maintenance.

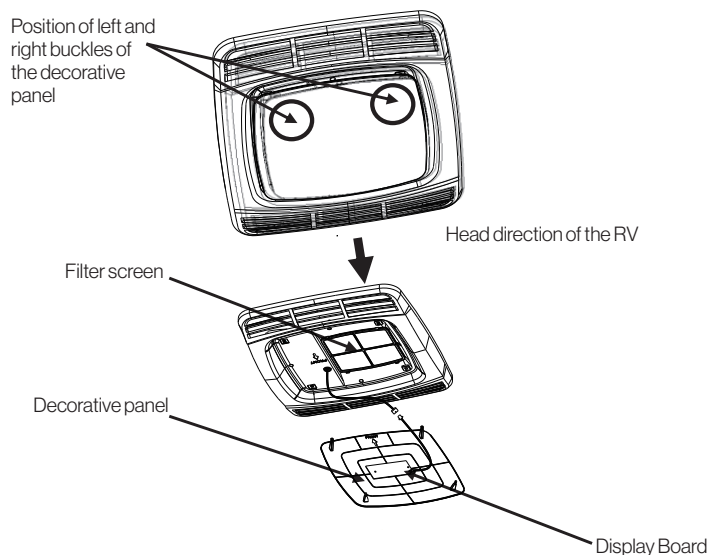

TROUBLESHOOTING

- If the air conditioning equipment cannot work normally, please carry out inspection as follows to remove the faults:
- Check whether the fuse of air conditioning equipment or leakage circuit breaker of the RV is turned on; If the air conditioner is powered by a generator, please first confirm whether the generator power matches the air conditioner, whether the generator runs normally and generates electricity, and whether voltage output of the generator is stable.

- If the RV is connected to shorepower pedestal, please make sure that the rating line matches the operating load of this product and that there is power supply.
- Check whether the connecting wires of air conditioner are inserted in place and connected in good condition.
- If the air conditioner still cannot work normally after the above inspection, please contact Furrion or Furrion authorized service agent.

NOTE: the equipment must be repaired by qualified personnel.

ERROR CODE OF DISPLAY BOARD

Code	Cause	Solution
E1	Fault of indoor temperature sensor	Check the sensor butt joint and replace the temperature sensing head if necessary.
E2	Fault of indoor coil temperature sensor	Check the sensor butt joint and replace the temperature sensing head if necessary.
E3	Fault of outdoor coil temperature sensor	Check the sensor butt joint and replace the temperature sensing head if necessary.
E4	Fault of outdoor ambient temperature sensor	Check the sensor butt joint and replace the temperature sensing head if necessary.

NOTE: when the display board displays “df”, it does not indicate a fault, but the air conditioner is defrosting.

CIRCUIT DIAGRAM OF OUTDOOR UNIT AND PANEL

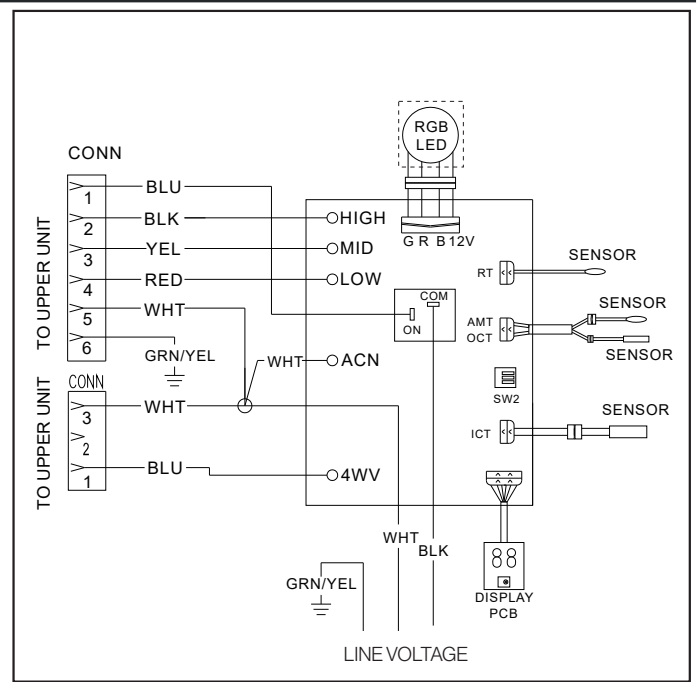
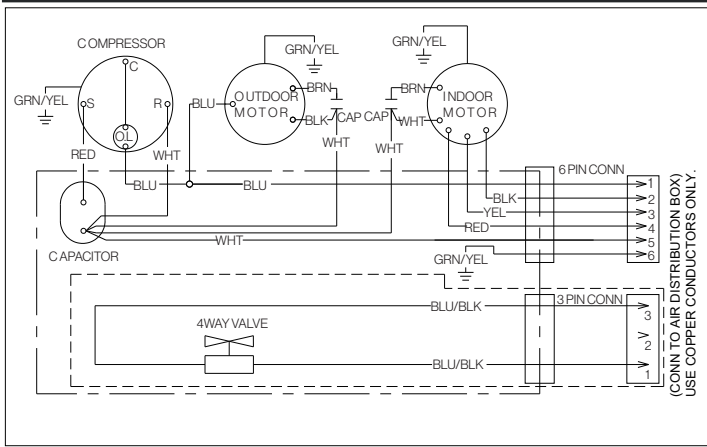

English

INSTALLATION EXPLODED DRAWING

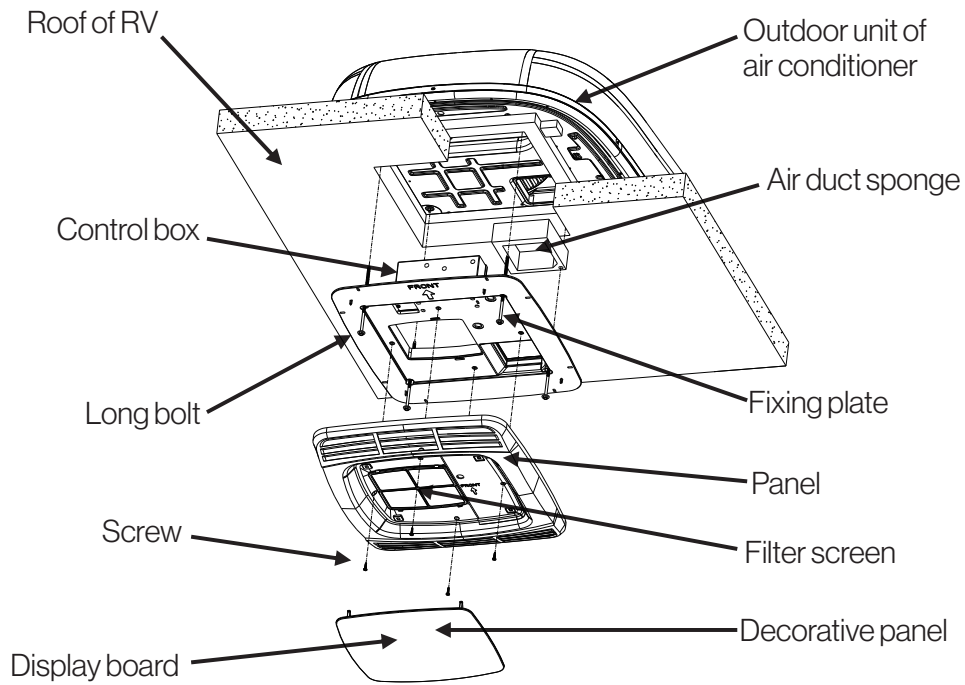



FURRION

Furrion Innovation Center & Institute of Technology

- 4/F, Flat C & D, The Grid, 133 Wai Yip Street, Kwun Tong, Kowloon, Hong Kong • Toll free: +1-432-547-7378
- Email: support@furrion.com

©2007-2023 Furrion Ltd. Furrion® and the Furrion logo are trademarks licensed for use by Furrion Ltd. and registered in the U.S. and other countries.

FURRION.COM